

PANEL NO.	GRANTOR	GRANTEE	DATE OF INSTRUMENT	DATE OF INSTRUMENT	REMARKS
1	JOHN CLYDE ET AL	D & R C CO	DEED	5-1-1834	
2	JOHN CLYDE ET AL	DO	DO	9-1-1834	
3	JOSEPH BONAPARTE	DO	DO	5-1-1833	
4	CHARLES GILBERT	DO	DO	11-8-1832	
5	ROBERT GILL JR ET AL	DO	DO	5-1-1833	
6	JOHN W PEARSON ET AL	DO	DO	3-1-1834	
7	WM NORTON ET AL	DO	DO	12-24-1833	
8	JOHN PANCOAST	DO	DO	4-11-1833	
9	WM ABBOTT	DO	CONDEMN	5-3-1833	
10	BENJ VAN SCHICK	DO	DO	5-3-1833	
11 & 12	ANDERSON LALOR	DO	DEED	9-1-1842	O R 14 P 26
254	JOSEPH NAPOLION BONAPARTE	DO	DO	11-17-1845	
255	JOSEPH NAPOLION BONAPARTE	DO	DO	11-7-1845	
256	BENNINGTON GILLET ET AL	DO	DO	10-26-1852	
257	KENNETH SCOBY ET AL	DO	DO	3-28-1856	
258	WM NORTON	DO	DO	10-30-1853	
259	WM CHAPMAN ET AL	DO	DO	10-30-1852	
260	EDMUND ABBOTT ET AL	DO	DO	9-24-1852	
261	CHARLES MOYER ET AL	DO	DO	12-2-1852	
262	WM GRANT ET AL	DO	DO	4-26-1854	O R 15 P 20
317	JOSEPH NAPOLION BONAPARTE	CARRAT CO	DO	12-26-1845	
13584	MANDRE & TRUST CO	UNJ R R CO	DO	1-23-1917	RECORD BOOK 2128 PG 3. DEED RECORDED CASE NO 1034. REC'D BY D. B. 234 IN 304. MAR 2 1917.
342	JOHN L MCKNIGHT, ET AL	CARRAT CO	DO	7-27-1868	VOL G-256
343	FRANCIS H. CLINTON ET AL	DO	DO	8-31-1868	VOL G-258

LEGEND

Areas colored RED are to remain in railroad company ownership.

Areas colored YELLOW are to be transferred from railroad company ownership to State of New Jersey by quit-claim deed, dated _____.

Areas enclosed by hatched lines are occupied by railroad facilities; the railroad companies retain a perpetual easement over these areas. They also retain a perpetual easement over such areas as are necessary for the maintenance and operation of all railroad facilities on lands colored yellow to be conveyed to the State by quit-claim deed; such areas to extend not less than twelve feet from the center line of each track measured on the side of the base of rail, with right to maintain slopes cut or fill as the conditions may require.

FOR STATE OF NEW JERSEY:

Henry R. ...
 DIRECTOR OF THE DEPARTMENT OF CONSERVATION AND DEVELOPMENT.

FOR THE UNITED NEW JERSEY RAILROAD AND CANAL CO.
 FOR THE PENNSYLVANIA RAILROAD CO.

...
 CHIEF ENGINEER, N.Y. ZONE

No 47500
 MAP SHOWING DELAWARE AN
 CANAL AND FEEDER IN THE
 STATE OF NEW JERSEY
 AS OF JUNE 12, 1934.
 SCALE: 1" = 400' LINE 1, 1932 DEV.

OFFICE OF CHIEF ENGINEER, NEW YORK ZONE
 PENNSYLVANIA STATION, NEW YORK, N.Y.

Labor Street
 South 5000 to
 City Line (lock 2 area)
 sold to Trenton 1937

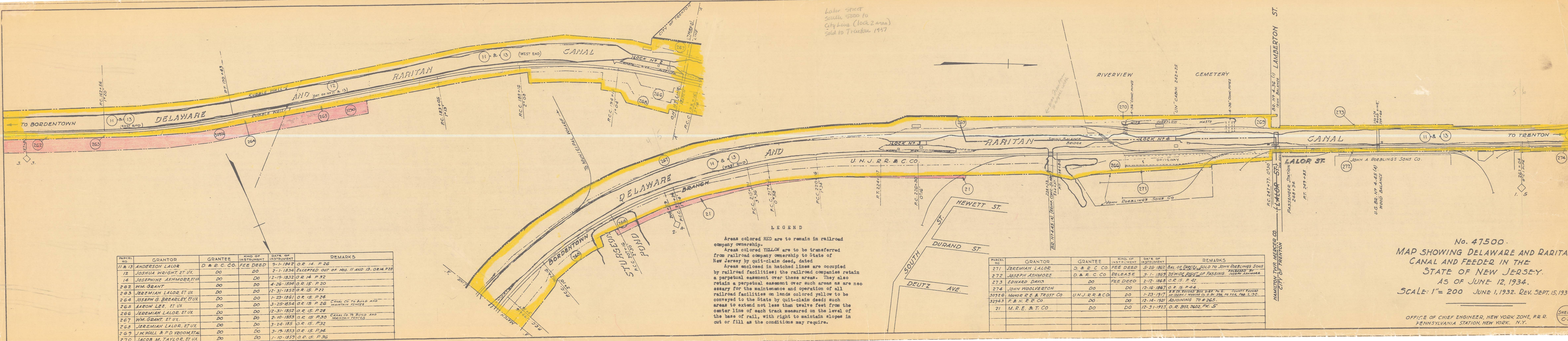

LEGEND

Areas colored RED are to remain in railroad company ownership.
 Areas colored YELLOW are to be transferred from railroad company ownership to State of New Jersey by quit-claim deed, dated [blank].
 Areas enclosed in hatched lines are occupied by railroad facilities; the railroad companies retain a perpetual easement over these areas. They also retain a perpetual easement over such areas as are necessary for the maintenance and operation of all railroad facilities on lands colored yellow to be conveyed to the State by quit-claim deed; such areas to extend not less than twelve feet from the center line of each track measured on the level of the base of rail, with right to maintain slopes in cut or fill as the conditions may require.

PARCEL NO.	GRANTOR	GRANTEE	KIND OF INSTRUMENT	DATE OF INSTRUMENT	REMARKS
11 & 13	ANDERSON LALOR	D & R. C. CO.	FEE DEED	9-1-1842	O.R. 14. P. 26
12	JOSHUA WRIGHT, ET UX	DO	DO	2-1-1834	EXCEPTED OUT OF NOS. 11 AND 13. O.R. 14. P. 28
14	JOSEPHINE ASHMORE, ET UX	DO	DO	12-19-1832	O.R. 14. P. 32
262	WM. GRANT	DO	DO	4-26-1854	O.R. 15. P. 20
263	JEREMIAH LALOR, ET UX	DO	DO	12-31-1852	O.R. 15. P. 22
264	JOSEPH G. BREARLEY, ET UX	DO	DO	1-23-1861	O.R. 15. P. 24
265	AARON LEE, ET UX	DO	DO	3-25-1854	O.R. 15. P. 26 CANAL CO TO BUILD AND MAINTAIN FENCES
266	JEREMIAH LALOR, ET UX	DO	DO	12-31-1852	O.R. 15. P. 28
267	WM. GRANT, ET UX	DO	DO	2-10-1853	O.R. 15. P. 30 CANAL CO TO BUILD AND MAINTAIN FENCES
268	JEREMIAH LALOR, ET UX	DO	DO	3-24-185	O.R. 15. P. 32
269	J.W. WALL & P.D. VROOM, ET AL	DO	DO	3-19-1853	O.R. 15. P. 34
270	JACOB M. TAYLOR, ET UX	DO	DO	1-10-1855	O.R. 15. P. 36

PARCEL NO.	GRANTOR	GRANTEE	KIND OF INSTRUMENT	DATE OF INSTRUMENT	REMARKS
271	JEREMIAH LALOR	D & R. C. CO.	FEE DEED	5-26-1862	BAL. OF PARCEL SOLD TO JOHN ROEBLING'S SONS
272	JOSEPH ASHMORE	D & R. C. CO.	RELEASE	3-1-1869	20' WIDE RIGHT OF PASSING. JOSEPH ASHMORE
273	EDWARD DAVIS	DO	FEE DEED	2-12-1868	O.R. 15. P. 42
274	JOHN WOOLVERTON	DO	DO	12-16-1867	O.R. 15. P. 44
30926	MANOR R. E. & TRUST CO.	U.N.J.R.R. & C.Co.	DO	1-23-1917	R.R. CO. RECORD BOX 5188, P. 6. COUNTY RECORD NO. 3289-1, MERCER CO. D.B. 398, P. 256, FEB. 2, 1917.
32943	P. & N. R. R. CO.	DO	DO	12-14-1921	ADJOINING TO # 265.
21	M. R. E. & T. CO.	DO	DO	12-31-1923	O.R. BOX 2602, PK. 5

No. 47500.
 MAP SHOWING DELAWARE AND RARITAN
 CANAL AND FEEDER IN THE
 STATE OF NEW JERSEY.
 AS OF JUNE 12, 1934.
 SCALE: 1" = 200' JUNE 1, 1932. REV. SEPT. 15, 1934.

OFFICE OF CHIEF ENGINEER, NEW YORK ZONE, P.R.R.
 PENNSYLVANIA STATION, NEW YORK, N.Y.

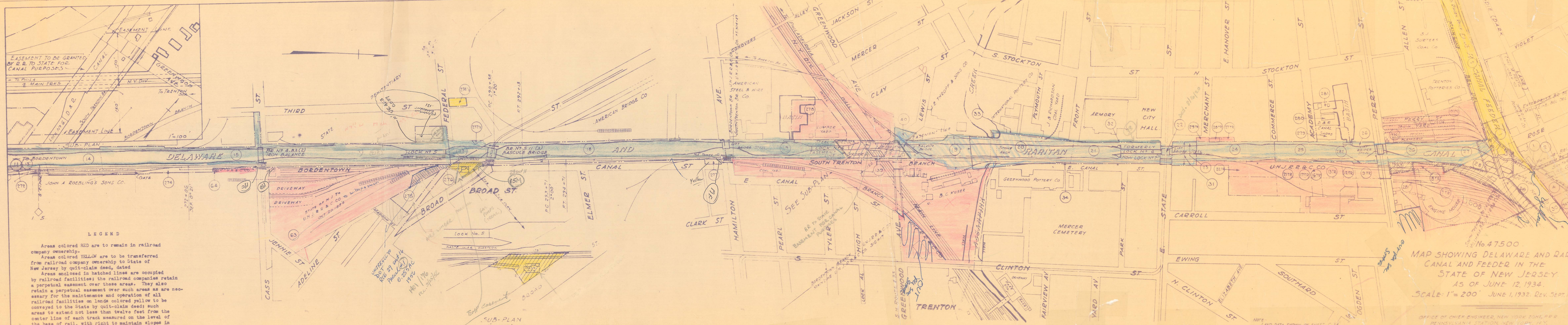

LEGEND

Areas colored RED are to remain in railroad company ownership.

Areas colored YELLOW are to be transferred from railroad company ownership to State of New Jersey by quit-claim deed, dated _____

Areas enclosed in hatched lines are occupied by railroad facilities; the railroad companies retain a perpetual easement over these areas. They also retain a perpetual easement over such areas as are necessary for the maintenance and operation of all railroad facilities on lands colored yellow to be conveyed to the State by quit-claim deed; such areas to extend not less than twelve feet from the outer line of each track measured on the level of the base of rail, with right to maintain slopes in cut or fill as the conditions may require.

No 47500
 MAP SHOWING DELAWARE AND RARITAN CANAL AND FEEDER IN THE STATE OF NEW JERSEY AS OF JUNE 12, 1934.
 SCALE: 1" = 200' JUNE 1, 1932. REV. SEPT. 15, 1934.

OFFICE OF CHIEF ENGINEER, NEW YORK ZONE, P.R.R. PENNSYLVANIA STATION, NEW YORK, N.Y.

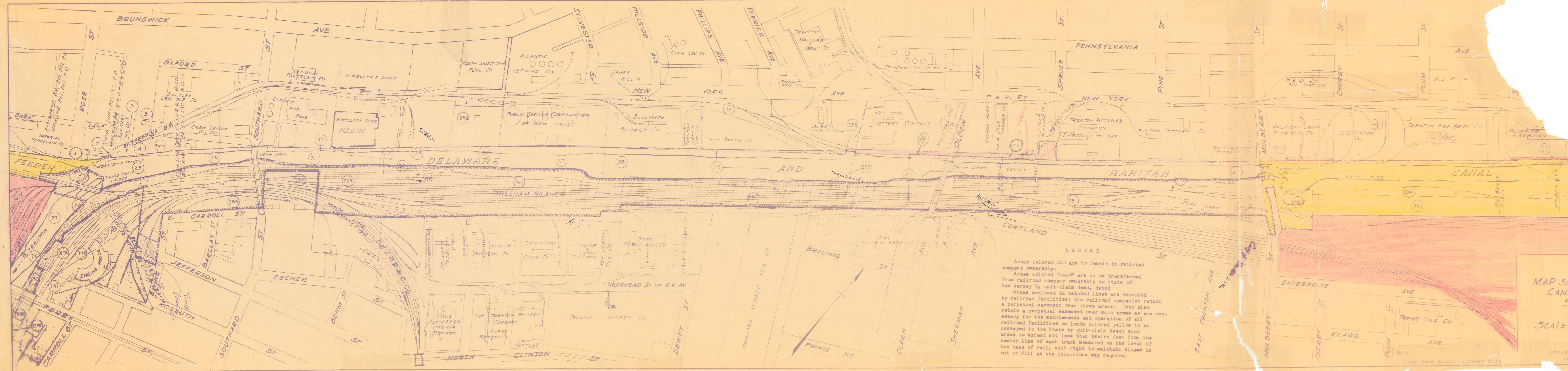

LEGEND

Areas colored RED are to remain in railroad company ownership.

Areas colored YELLOW are to be transferred from railroad company ownership to State of New Jersey by quit-claim deed, dated _____

Areas enclosed in hatched lines are occupied by railroad facilities; the railroad companies retain a perpetual easement over these areas. They also retain a perpetual easement over such areas as are necessary for the maintenance and operation of all railroad facilities on lands colored yellow to be conveyed to the State by quit-claim deed; such areas to extend not less than twelve feet from the center line of each track measured on the level of the base of rail, with right to maintain slopes in cut or fill as the conditions may require.

MAP SHOWING
CANAL
STREETS
SCALE: 1" = 100'

NOTE
LAND DATA SHOWN ON SHEET C-34

PARCEL NO.	GRANTOR	GRANTEE	KIND OF INSTRUMENT	DATE OF INSTRUMENT	REMARKS
11 & 13	ANDERSON LALOR	D & R C. CO.	FEE DEED	9-1-1842	O.R. 14, P. 26
14	JOSEPH ASHMORE, ET UX	DO	DO	12-19-1832	O.R. 14, P. 32
15	EVAN EVANS, ET UX	DO	DO	2-4-1833	O.R. 14, P. 34
16	SAMUEL F. MACCRACKEN	DO	DO	4-1-1833	O.R. 14, P. 36
17					NO RECORD. STREETS O.R. 14, P. 43
18	WM. E. HUNT	D & R C. CO.	FEE DEED	8-1-1837	O.R. 14, P. 40
19	B. STOCKTON, TRUSTEE	U.N.J. R.R. & C. CO.	DO	5-6-1902	O.R. 14, P. 43 (SEE NOTE BELOW)
20	LEWIS WALN	D & R C. CO.	DO	3-18-1835	O.R. 14, P. 44
21	WM. E. HUNT	DO	DO	12-1-1831	O.R. 14, P. 46
22					STREET
23	JOHN MCKELWAY, ET UX	D & R C. CO.	FEE DEED	11-23-1831	O.R. 14, P. 50
24	CONVEYED TO ROBT. F. STOCKTON FOR D. R. CANAL CO.	D. R. CANAL CO.			NO RECORD O.R. 14, P. 52.
25	ELIZABETH L. HIGBEE, ET AL	D & R C. CO.	FEE DEED	1-1-1834	O.R. 14, P. 54
26	CHARLES PARKER, ET UX	DO	DO	11-25-1831	O.R. 14, P. 58
27	WM. E. HUNT	DO	DO	12-1-1831	SHOWS AS NO. 1 ON FEEDER PLAN, F. B. 2014, PG. 2
28	EBENEZER P. ROSE, ET UX	DO	DO	3-1-1832	O.R. 14, P. 62
29	CHARLES PARKER, ET UX	DO	DO	11-25-1837	O.R. 14, P. 66
30	SARAH LEAKE, ET AL	DO	DO	12-12-1831	O.R. 14, P. 68
31	ANDREW ALLISON	DO	DO	6-29-1831	O.R. 8, P. 58
32	WM. E. HUNT	D & R C. CO.	DO	10-20-1836	ALL BUT 80 FROM FRONT ST. DEDICATED TO CITY
33-34	LEWIS WALN	D & R C. CO.	DO	4-3-1839	O.R. 8, P. 62 Two PLS IN DEED.
272	JOSEPH ASHMORE	D & R C. CO.	RELEASE	3-1-1869	20' WIDE POT PASSING, RELEASED BY J. ASHMORE
274	JOHN WOOLVERTON	DO	FEE DEED	12-16-1867	O.R. 15, P. 44
274 1/2	SAMUEL EVANS, ET UX	DO	DO	1-5-1853	O.R. 15, P. 46. STABBT.
275	CHARLES MEGILL, ET AL	DO	DO	6-4-1850	O.R. 15, P. 48
276	WM. E. HUNT, ET UX	DO	DO	10-1-1833	O.R. 15, P. 50
277	WM. E. HUNT, ET UX	DO	DO	10-1-1833	O.R. 15, P. 50
277 1/2	WM. MCKNIGHT, ET UX	DO	DO	4-18-1846	O.R. 15, P. 52
278	A. J. WHITTAKER, ET UX	DO	DO	10-31-1857	O.R. 15, P. 54
279	JOHN C. GRANT, ET UX	DO	DO	4-19-1854	O.R. 15, P. 56

PARCEL NO.	GRANTOR	GRANTEE	KIND OF INSTRUMENT	DATE OF INSTRUMENT	REMARKS
280	JOHN C. STEVENS, ET UX	D & R C. CO.	FEE DEED	9-8-1851	O.R. 15, P. 60
281	WM. G. COOK	DO	DO	6-20-1866	O.R. 15, P. 62
281 1/2	ELIAS COOK	BEL DEL R.R. CO.	DO	8-30-1853	R.R. CO. RECORD, BOX 432, P. 5 OR 11, PG. 4
282	CHARLES PARKER, ET UX	D & R C. CO.	DO	6-2-1842	O.R. 15, P. 64
283	CHARLES PARKER, ET UX	DO	DO	6-2-1842	O.R. 15, P. 64
7 TR	JOHN G. STEVENS, ET UX	C. R. R. & C. CO.	DO	8-20-1849	O.R. 8, P. 14
8 TR	CHARLES PARKER, ET UX	DO	DO	6-8-1849	O.R. 8, P. 16
9 TR	DO	DO	DO	6-8-1849	O.R. 8, P. 16
12 TR	LUCY ANN HIGBEE	DO	DO	5-23-1849	O.R. 8, P. 22
13 TR	JOHN H. MCINTOSH, ET UX	DO	DO	10-1-1849	O.R. 8, P. 24
16 TR	DO	DO	DO	9-20-1849	O.R. 8, P. 32
17 TR	LEWIS P. HIGBEE, ET UX	DO	DO	5-23-1849	O.R. 8, P. 34
21 TR	JACOB WALDBURG, ET UX	DO	DO	6-11-1849	O.R. 8, P. 40
22 TR	JAMES REDMOND, ET UX	DO	DO	6-17-1849	O.R. 8, P. 42
27 TR	JAMES M. REDMOND, ET UX	C. R. R. & C. CO.	FEE DEED	6-17-1849	O.R. 8, P. 42
28 TR	DO	DO	DO	6-17-1849	O.R. 8, P. 42
29 TR	DO	DO	DO	8-16-1839	O.R. 8, P. 54
63	STATE OF NEW JERSEY	U.N.J. R.R. & C. CO.	DO	10-20-1836	STATE RESERVES THE RIGHT TO PLACE & MAINTAIN A CANAL FEEDER.
19292	SAMUEL HEATH	BEL DEL R.R. CO.	DO	3-23-1904	REC 269, 509, BOX 1387, P. 4
19361	CHAS. M. HEATH	DO	DO	2-25-1904	
1	HEIRS OF JOHN J. SCHAFF	ENTERPRISE R.R. CO.	CONDEMN	1-6-1885	O.R. 8, P. 509
2	LUTHER S. COX, TRUSTEE	DO	FEE DEED	7-20-1885	O.R. 8, P. 504
3	OWEN DONNELLY	DO	CONDEMN	1-19-1885	O.R. 8, P. 507
4	BENJAMIN MEYERS	DO	DO	1-19-1885	O.R. 8, P. 510
5	RICHARD S. CONOVER	DO	FEE DEED	1-28-1885	O.R. 8, P. 500, R.R. CO. TO ERECT FENCES.
94 TR	DO	U.N.J. R.R. & C. CO.	DO	5-27-1892	O.R. 8, P. 195
64	VICTOR M. CAULKINS	DO	DO	9-27-1880	O.R. 8, P. 120
40	ZACHARIAH ROSSELL, TR.	D & R C. CO.	DO	10-2-1837	O.R. 8, P. 75
139	DO	DO	DO	10-2-1837	O.R. 7, P. 292

NOTE - PARCEL 19. DANIEL W. COXE ET UX TO ROBERT F. STOCKTON TR. FEE DEED 9-9-1833, REC BUR CO G-3 P. 270. \$422 ACQUIRED FOR D & R CANAL CO. (ROBERT STOCKTON DIED 10-7-1866 RICHARD STOCKTON HIS OLDEST SON DIED 4-24-1876 AND HIS OLDEST SON WAS BAYARD STOCKTON.)

NOTE - PARCELS Nos 139 & 278 ARE RETAINED BY AGREEMENT WITH DEPT OF CONSERVATION AND DEVELOPMENT.

SHEET C-3A

PARCEL NO.	GRANTOR	GRANTEE	KIND OF INSTRUMENT	DATE OF INSTRUMENT	REMARKS
27	WM. E. HUNT	D & R C. CO.	FEE DEED	12-1-1831	O.R. 14, P. 60
28	EBENEZER P. ROSE, ET UX	DO	DO	3-1-1832	O.R. 14, P. 62
29	CHARLES PARKER, ET UX	DO	DO	11-25-1837	O.R. 14, P. 66
30	SARAH LEAKE, ET AL	DO	DO	12-12-1831	O.R. 14, P. 68
31	WILLIAM POTTS, ET UX	DO	DO	11-15-1831	O.R. 14, P. 70
32	SARAH LEAKE, ET AL	DO	DO	12-12-1831	O.R. 14, P. 72
33	WILLIAM POTTS, ET AL	DO	CONDEMN.	7-17-1833	O.R. 14, P. 74
34	SAMUEL BREARLEY, ET UX	DO	FEE DEED	11-11-1831	O.R. 14, P. 76
35	WILLIAM POTTS, ET UX	DO	DO	11-15-1831	O.R. 14, P. 79
36	THOMAS LANGSTROTH, ET UX	DO	DO	4-2-1832	O.R. 14, P. 80
37	PETER T. SMITH	DO	DO	12-24-1831	O.R. 14, P. 82
38	SAMUEL MCLURG, ET UX	DO	DO	3-20-1832	O.R. 14, P. 86
39	CHARLES EWING	DO	DO	11-24-1831	O.R. 14, P. 88
40	CHARLES HIGBEE, ET UX	DO	DO	11-4-1831	O.R. 14, P. 90
41	SAMUEL DICKINSON, ET UX	DO	DO	10-22-1831	O.R. 14, P. 92
42	HENRY BELLERJEAN, ET UX	DO	DO	11-23-1831	O.R. 14, P. 94
290	J. A. CLARK	BEL DEL R.R. CO.	DO	4-28-1850	O.R. 11, P. 2, BOX 432, PG. 5
281 1/2	ELIAS COOK	DO	DO	8-30-1853	R.R. CO. RECORD, BOX 432, P. 5 OR 11, PG. 4.
283	CHARLES PARKER, ET UX	D & R C. CO.	DO	6-2-1842	O.R. 15, P. 64
284	JAMES DUNDAS, ET AL	DO	DO	6-27-1850	O.R. 15, P. 66
285	JOHN RINGWOOD, ET UX	DO	DO	6-1-1852	O.R. 15, P. 68
286	ANNA POTTS	DO	DO	3-31-1868	O.R. 15, P. 70
287	HENRY C. PRATT, ET AL	DO	DO	4-7-1855	O.R. 15, P. 72
288	WILLIAM D. HART	DO	DO	7-9-1853	O.R. 15, P. 76
289	PHILEMON DICKINSON	DO	DO	6-26-1852	INCLUDED WITHIN PARCELS 39 & 40 O.R. 15, P. 78
290	DO	DO	DO	9-8-1853	#290 & 291 INCL WITHIN PCL 41 O.R. 15, P. 80
291	DO	DO	DO	12-4-1854	DEPT. ENRANCED IN 1857 290 291 SOLD TO SAMUEL DEC. 1857. 292, 293 & 294 AFFORWARDED DEC. 1850 O.R. 15, P. 82
292	DO	DO	DO	6-26-1852	O.R. 15, P. 84
293	HENRY C. PRATT, ET AL	DO	DO	4-7-1855	STRIP 40 WIDE DEDICATED TO CITY OF TRENTON FOR CANAL. ENRANCED IN 1857 290 291 SOLD TO SAMUEL DEC. 1857. 292, 293 & 294 AFFORWARDED DEC. 1850 O.R. 15, P. 86 (SEE NOTE BELOW)
294	SAMUEL DICKINSON	DO	DO	9-8-1853	O.R. 15, P. 90
295	DO	DO	DO	9-8-1853	O.R. 15, P. 90
296	PHILEMON DICKINSON	DO	DO	10-4-1854	O.R. 15, P. 92
1	HEIRS OF JOHN J. SCHAFF	ENTERPRISE R.R. CO.	CONDEMN	1-6-1885	O.R. 8, P. 509
2	LUTHER S. COX, TRUSTEE	DO	FEE DEED	7-20-1885	O.R. 8, P. 504
3	OWEN DONNELLY	DO	CONDEMN	1-19-1885	O.R. 8, P. 507

NOTE - PARCEL 293. GRANTOR RESERVES THE RIGHTS TO TAKE WATER FROM CANAL FOR THEIR MILLS, WITH RIGHT TO RECOVER DAMAGES IF PREVENTED.

PARCEL NO.	GRANTOR	GRANTEE	KIND OF INSTRUMENT	DATE OF INSTRUMENT	REMARKS
4	BENJAMIN MEYERS	ENTERPRISE R.R. CO.	CONDEMN	1-19-1885	O.R. 8, P. 510
5	RICHARD S. CONOVER	DO	FEE DEED	1-28-1885	O.R. 8, P. 500, R.R. CO. TO ERECT FENCES.
94 TR	DO	U.N.J. R.R. & C. CO.	DO	5-27-1892	O.R. 8, P. 195
14	WILLIAM D. HART & TERESA MATHEWS	ENTERPRISE R.R. CO.	DO	8-27-1885	O.R. 8, P. 502
15	THE ENTERPRISE LAND CO.	DO	DO	5-14-1885	O.R. 8, P. 511
A-3	DANFORTH CHEMICAL CO.	BEL DEL R.R. CO.	DO	7-15-1904	BOX 1527, P. 6
32401	ESSENTIAL OIL CO.	DO	DO	6-8-1923	BOX 2526, P. 8, BK. 511, PG. 368
A-1	ENTERPRISE LAND CO.	DO	DO	10-19-1899	BOX 435, P. 3
A-2	TRENTON ROBE FERTILIZER CO.	DO	DO	10-19-1899	BOX 435, P. 4
A-4	BEL DEL R.R. CO. & JOINTLESS FIRE BRICK CO.	DO	DO	10-19-23	EST. PERMANENT DIVISION LINE

No. 47500
MAP SHOWING DELAWARE AND RARITAN CANAL AND FEEDER IN THE STATE OF NEW JERSEY.
AS OF JUNE 12, 1934.
JUNE 1, 1932. REV. SEPT. 15, 1934.

OFFICE OF CHIEF ENGINEER, NEW YORK ZONE R.R. CO. PENNSYLVANIA STATION, NEW YORK, N.Y.

SHEET C-3A

LEGEND

Areas colored RED are to remain in railroad company ownership.

Areas colored YELLOW are to be transferred from railroad company ownership to State of New Jersey by quit-claim deed, dated

Areas enclosed in hatched lines are occupied by railroad facilities; the railroad companies retain a perpetual easement over these areas. They also retain a perpetual easement over such areas as are necessary for the maintenance and operation of all railroad facilities on lands colored yellow to be conveyed to the State by quit-claim deed; such areas to extend not less than twelve feet from the center line of each track measured on the level of the base of rail, with right to maintain slopes in cut or fill as the conditions may require.

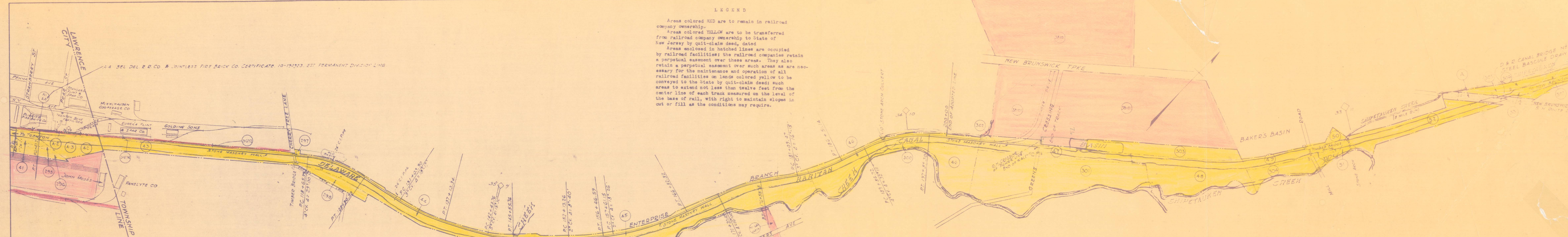

PARCEL NO.	GRANTOR	GRANTEE	KIND OF INSTRUMENT	DATE OF INSTRUMENT	REMARKS
A1	ENTERPRISE LAND CO	BEL DEL R R CO	FEE DEED	10-19-1899	Bx 435 P 3
A2	TRENCH BONE FERTILIZER CO	DO	DO	10-19-1899	Bx 435 P 4
A3	DANFORTH CHEMICAL CO	DO	DO	7-15-1904	Bx 1527 P 6
42	HENRY BELLERJEAU, JR	D & R C Co	DO	11-23-1831	O R 14 P 94
43	THOMAS CAPNER, JR, ET UX	DO	DO	1-12-1832	O R 14 P 96
44	HANNAH STEVENS, ET AL	DO	DO	11-1-1831	O R 14 P 98
45	RUBEN HUNT, ET UX	DO	DO	9-17-1831	O R 14 P 100, CANAL CO TO BUILD FENCES
46	RALPH M. MERSHON	DO	DO	11-25-1831	O R 14 P 102
47	JOEL TINDALL, ET UX	DO	DO	3-13-1832	O R 14 P 104
48	BENJAMIN BAKER, ET AL	DO	DO	7-16-1832	O R 14 P 106
49	BENJAMIN BAKER, ET UX	DO	DO	1-3-1832	O R 14 P 108
50	PHEBE COKE	DO	DO	4-1-1833	O R 14 P 110
51	BENJAMIN BAKER, ET UX	DO	DO	1-3-1832	O R 14 P 112

PARCEL NO.	GRANTOR	GRANTEE	KIND OF INSTRUMENT	DATE OF INSTRUMENT	REMARKS
52	ISRAEL CLARK, ET UX	D & R C Co	FEE DEED	12-13-1831	O R 14 P 114
53	MULDAH PHILLIPS, ET AL	DO	DO	10-1-1831	O R 14 P 116
54	ISAAC BREARLEY, ET UX	DO	DO	11-10-1831	O R 14 P 118
295	SAMUEL DICKINSON	DO	DO	9-8-1853	O R 15 P 90
297	HANNAH STEVENS, ET AL	DO	DO	11-1-1834	O R 15 P 94
298	HANNAH STEVENS, ET AL	DO	DO	11-1-1834	O R 15 P 94
299	VALEIA HUNT, ET AL	DO	DO	2-1-1834	O R 15 P 96
300	ANN M. HUTCHINSON, ET AL	DO	DO	8-5-1834	O R 15 P 98 (SEE NOTE)
301	JOEL TINDALL, ET UX	DO	DO	5-1-1835	O R 15 P 100
302	ISRAEL H. BLACKWELL, JR	DO	DO	2-12-1861	O R 15 P 102
303	ISRAEL H. BLACKWELL, JR	DO	DO	8-9-1861	O R 15 P 104
304	BENJAMIN BAKER	DO	DO	6-24-1842	O R 15 P 106
305	JAMES A. PHILLIPS, ET AL	DO	DO	12-2-1833	O R 15 P 108

PARCEL NO.	GRANTOR	GRANTEE	KIND OF INSTRUMENT	DATE OF INSTRUMENT	REMARKS
306	THOMAS S. STEVENS, ET AL	D & R C Co	FEE DEED	10-2-1872	O R 15 P 110
307	JAMES A. PHILLIPS, ET UX	DO	DO	10-16-1857	O R 15 P 112
31672	GEO. L. ATKINS	BEL DEL R R CO	DO	11-21-1917	BOX 2218 Pk 5 REC BY 404 Pg. 175
31674	EUREKA FLINT & SPAR CO	DO	DO	2-25-1918	2252 3 407 401
36808	M. R. E. & T. CO.	UNJ R R & CO	DO	5-29-1929	2407 112 651 433
38101	HARRY J. BAUDOT, JR	BEL DEL R R CO	DO	3-3-1930	3 PARCELS, BOX 2366 P 11
296	PHILEMON DICKINSON	D & R C Co	DO	12-4-1854	O R 5 P 92
41	SAMUEL DICKINSON, ET UX	DO	DO	12-22-1831	O R 14 P 92
52	ISAAC B. BAKER, ET UX	DO	DO	10-4-1862	O R 14 P 115
A	UNJ R R & C CO	STATE OF NJ	GRANT	2-10-1932	FOR STATE ROAD IMPROVING

NOTE: THERE ARE 3 OUTSTANDING INTERESTS. NO PAPERS TO SHOW CONVEYANCES INTO D & R CANAL CO

No. 47500
 MAP SHOWING DELAWARE AND RARITAN CANAL AND FEEDER IN THE STATE OF NEW JERSEY
 AS OF JUNE 12, 1934.
 SCALE: 1" = 400' JUNE 1, 1932. REV. SEPT. 15, 1934.
 OFFICE OF CHIEF ENGINEER, NEW YORK ZONE, PRR PENNSYLVANIA STATION, NEW YORK, N.Y.

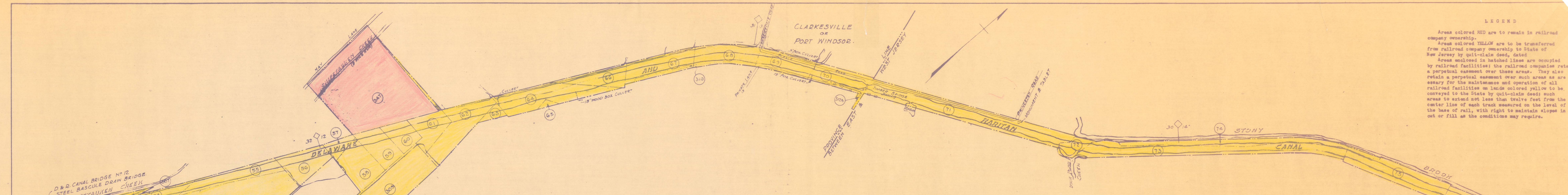

LEGEND

Areas colored RED are to remain in railroad company ownership.
 Areas colored YELLOW are to be transferred from railroad company ownership to State of New Jersey by quit-claim deed, dated _____
 Areas enclosed in hatched lines are occupied by railroad facilities; the railroad companies retain a perpetual easement over these areas. They also retain a perpetual easement over such areas as are necessary for the maintenance and operation of all railroad facilities on lands colored yellow to be conveyed to the State by quit-claim deed; such areas to extend not less than twelve feet from the center line of each track measured on the level of the base of rail, with right to maintain slopes in cut or fill as the conditions may require.

PARCEL NO.	GRANTOR	GRANTEE	KIND OF INSTRUMENT	DATE OF INSTRUMENT	REMARKS
53	HULDAH PHILLIPS, ET AL	D. & R. C. CO.	FEE DEED	10-1-1831	O. R. 14 P. 116
54	ISAAC BREARLEY, ET UX	DO	DO	11-10-1831	O. R. 14 P. 118
55	JOHN BREARLEY, ET UX	DO	DO	12-14-1831	O. R. 14 P. 120
56	WILLIAM GROVER, ET UX	DO	DO	1-12-1832	O. R. 14 P. 122
57	REV ISAAC V. BROWN, ET UX	DO	DO	2-22-1831	O. R. 14 P. 124
58	ENOCH JOHNSON, ET UX	DO	DO	12-23-1831	O. R. 14 P. 126
59	JAMES A. PHILLIPS, ET UX	DO	DO	10-1-1831	O. R. 14 P. 128
60	REV ISAAC V. BROWN, ET UX	DO	DO	12-22-1831	O. R. 14 P. 130
61	SAMUEL D. MERRISON, ET UX	DO	DO	10-25-1831	O. R. 14 P. 132
62	ISAAC BREARLEY, ET UX	DO	DO	11-10-1831	O. R. 14 P. 134
63	EDWARD LANVING, ET UX	DO	DO	2-29-1832	O. R. 14 P. 136
64	ANN MENDRICKSON, ADM.	DO	DO	3-1-1834	O. R. 14 P. 138
65	FR. ISRAEL LARK, ET UX	DO	DO	12-13-1831	O. R. 14 P. 140
66	JOHN AGNEW, ET AL	DO	DO	7-2-1832	O. R. 14 P. 142
67	GEO. PHILLIPS, ET UX	DO	DO	9-22-1831	O. R. 14 P. 144
68	JOHN AGNEW, ET AL	DO	DO	7-21-1832	O. R. 14 P. 146
69	HENRY D. PHILLIPS, ET UX	DO	DO	2-1-1832	O. R. 14 P. 148
70	JOSEPH PHILLIPS, ET UX	DO	DO	1-10-1832	O. R. 14 P. 150
71	JOSEPH GILLINGHAM, ET UX	DO	DO	3-25-1839	O. R. 14 P. 152
72	JOSEPH O. CLARK, ET UX	DO	DO	11-25-1831	O. R. 14 P. 154

PARCEL NO.	GRANTOR	GRANTEE	KIND OF INSTRUMENT	DATE OF INSTRUMENT	REMARKS
73	ELIAS THEODORE SCHENCK, ET UX	D. & R. C. CO.	FEE DEED	2-2-1833	O. R. 14 P. 158
74	JOSEPH O. CLARK, ET UX	DO	DO	11-25-1831	O. R. 14 P. 160
75	JOHN W. SCOTT	DO	DO	4-30-1832	O. R. 14 P. 162
76	SARAH CLARK	DO	DO	12-23-1831	O. R. 14 P. 164
77	JOSEPH CLARK	DO	DO	12-23-1831	O. R. 14 P. 166
305	JAMES A. PHILLIPS, ET AL	DO	DO	2-2-1833	O. R. 15 P. 108
306	THOMAS S. STEVENS, ET AL	DO	DO	10-2-1872	O. R. 15 P. 110
307	JAMES A. PHILLIPS, ET UX	DO	DO	10-16-1857	O. R. 15 P. 112
308	MATILDA BREARLEY, ET AL	DO	DO	10-10-1846	O. R. 15 P. 114
309	SAMUEL S. HART, ET AL	DO	DO	8-30-1851	O. R. 15 P. 116
310	JAMES ARONSMITH, ET UX	DO	DO	9-21-1854	O. R. 15 P. 118
327a	HENRY D. PHILLIPS, ET UX	DO	DO	4-20-1841	O. R. 15 P. 122
347	JOHN S. PHILLIPS, ET AL	UN. J. R. & C. CO.	DO	9-11-1883	O. R. 15 P. 125
A	UN. J. R. & C. CO.	STATE OF N. J.	GRANT.	2-10-1932	FOR STATE ROAD WIDENING

No. 47500
 MAP SHOWING DELAWARE AND RARITAN CANAL AND FEEDER IN THE STATE OF NEW JERSEY.
 AS OF JUNE 12, 1934.
 SCALE: 1" = 400' JUNE 1, 1932. REV. SEPT. 15, 1934.

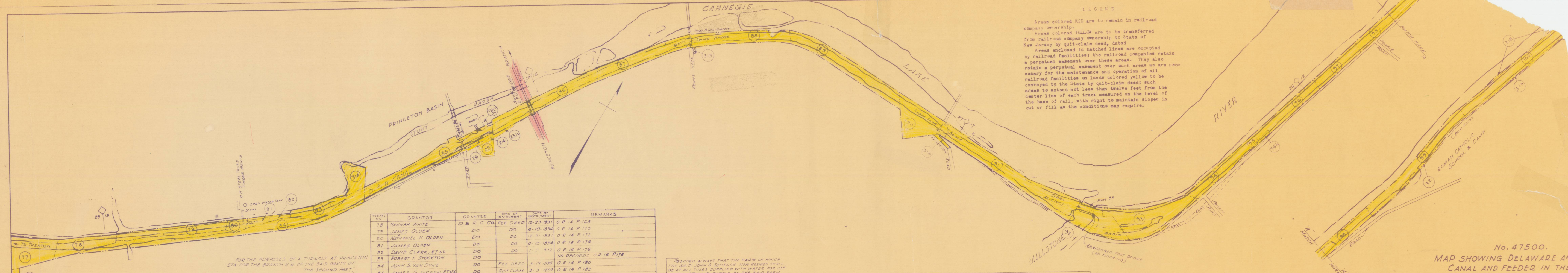

LEGEND
 Areas colored RED are to remain in railroad company ownership.
 Areas colored YELLOW are to be transferred from railroad company ownership to State of New Jersey by quit-claim deed, dated
 Areas enclosed in hatched lines are occupied by railroad facilities; the railroad companies retain a perpetual easement over these areas. They also retain a perpetual easement over such areas as are necessary for the maintenance and operation of all railroad facilities on lands colored yellow to be conveyed to the State by quit-claim deed; such areas to extend not less than twelve feet from the center line of each track measured on the level of the base of rail, with right to maintain slopes in cut or fill as the conditions may require.

FOR THE PURPOSES OF A TURNOUT AT PRINCETON STA. FOR THE BRANCH R.R. OF THE SAID PARTY OF THE SECOND PART.

PROVIDED ALWAYS THAT THE FARM ON WHICH THE SAID JOHN G. SCHENCK NOW RESIDES SHALL BE AT ALL TIMES SUPPLIED WITH WATER FOR USE OF THE STOCK & CATTLE ON THE SAID FARM BY THE SAID COMPANY FROM THE CANAL.

C & A R R & C O. MERGED WITH OTHER R.R.'S TO FORM UN J R R & C O. CO. 3-14-1872.

PARCEL NO.	GRANTOR	GRANTEE	KIND OF INSTRUMENT	DATE OF INSTRUMENT	REMARKS
91	WILLIAM BICKNER, ETUX	D & R C CO	DEED	2-4-1832	
92	ISAAC SCUDDER	DO			NO RECORD
93	JOHN HEATH, ETUX	DO	DEED	4-14-1832	
94	AUSTIN D. BLACKWELL, ETUX	DO	DO	4-20-1832	
94 1/2	DO	DO	DO	4-20-1832	
95	ISAAC STORY	DO	CONDEMN	10-30-1839	ISAAC STORY ASSIGNEE OF JOHN G. SCHENCK
96	JACOB VAN DIKE, ETUX	DO	DEED	1-7-1832	
97	SIMON VAN DIKE, ETUX	DO	DO	12-29-1831	
98	ABRAHAM CRUISER	DO	DO	12-28-1831	
99	HENRY VAN DYKE	DO	DO	12-9-1831	

PARCEL NO.	GRANTOR	GRANTEE	KIND OF INSTRUMENT	DATE OF INSTRUMENT	REMARKS
78	MANNAN WHITE	D & R C CO	FEE DEED	12-23-1831	OR 14 P 168
79	JAMES OLDEN	DO	DO	4-10-1834	OR 14 P 170
80	NATHANIEL H. OLDEN	DO	DO	12-31-1831	OR 14 P 172
81	JAMES OLDEN	DO	DO	4-10-1834	OR 14 P 174
82	DAVID CLARK, ETUX	DO	DO	1-2-1832	OR 14 P 176
83	ROBERT F. STOCKTON	DO			NO RECORDS OR 14 P 178
84	JOHN S. VAN DYKE	DO	FEE DEED	9-19-1835	OR 14 P 180
85	JAMES G. GREEN, ETUX	DO	QUIT CLAIM	4-3-1829	OR 14 P 182
86	EMMALINE & JAS. STOUT	DO	FEE DEED	11-22-1834	OR 14 P 184
87	JOHN G. SCHENCK, ETUX	DO	DEED	1-7-1832	OR 14 P 186 (SEE NOTE)
26	JOHN JEROLAMAN	C & A R R & C O.	FEE DEED	1-23-1850	OR 7 P 500 SEE NOTE
23 1/2	JAMES H. GULICK, ETUX	DO	DEED	6-27-1863	OR 7 P 437 (LIMITED) DO
74	JAMES S. GREEN, ETUX	DO	FEE DEED	7-27-1850	OR 7 P 456 DO
25	JAMES S. GREEN, ETUX	DO	FEE DEED	3-8-1852	OR 7 P 458 DO
22 1/2	HOWARD R. BUTLER	UN J R R & C O.	FEE DEED	11-13-1906	(300) ON PRINCETON BR OR 7 P 575
34	JOHN S. VAN DYKE	D & R C CO	FEE DEED	2-2-1832	OR 15 P 126
88	WILLIAM KOVENHOVEN, ETUX	DO	DO	9-7-1832	
89	HEIRS OF BENJAMIN JULY N	DO			NO RECORD
90	WILLIAM KOVENHOVEN, ETUX	D & R C CO	DEED	9-7-1832	

PARCEL NO.	GRANTOR	GRANTEE	KIND OF INSTRUMENT	DATE OF INSTRUMENT	REMARKS
100	MATTHEW VAN DYKE, ETUX	D & R C CO	DEED	1-27-1832	
315	WILLIAM KOVENHOVEN, ETUX	DO	DO	3-12-1835	
316	WILLIAM BICKNER, ETUX	DO	DO	1-16-1835	
318	WILLIAM J. VAN DYKE, ETUX	D & R C CO	DEED	1836	RECORDED 8-22-1816
319	DO	DO	DO	1-15-1840	
22	H. VAN DYKE	C & A R R & C O.	DO	3-8-1841	

No. 47500.
 MAP SHOWING DELAWARE AND RARITAN CANAL AND FEEDER IN THE STATE OF NEW JERSEY AS OF JUNE 12, 1934.
 SCALE: 1" = 400' JUNE 1, 1932. REV. SEPT. 15, 1934.

OFFICE OF CHIEF ENGINEER, NEW YORK ZONE, P. R. & PENNSYLVANIA STATION, NEW YORK, N. Y.

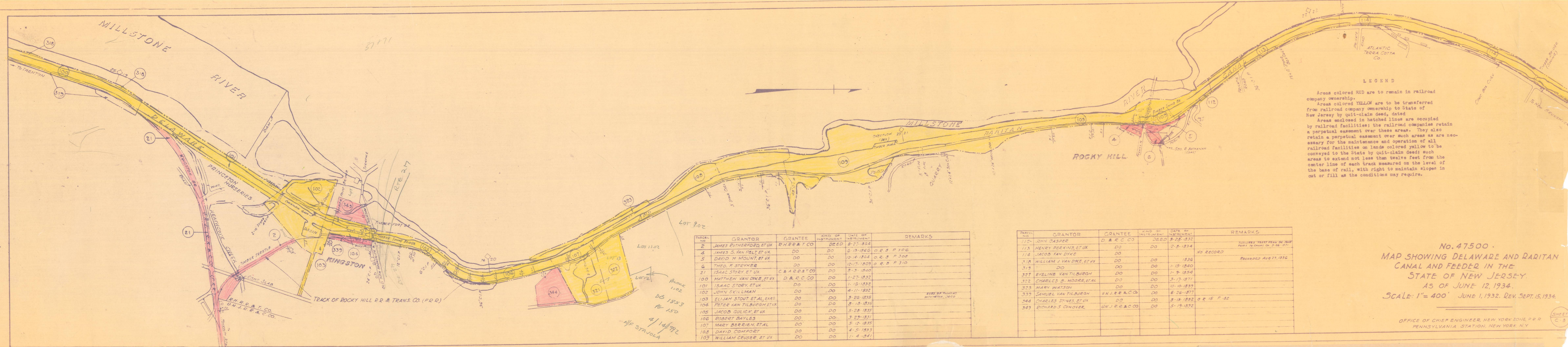

LEGEND

Areas colored RED are to remain in railroad company ownership.

Areas colored YELLOW are to be transferred from railroad company ownership to State of New Jersey by quit-claim deed, dated _____.

Areas enclosed in hatched lines are occupied by railroad facilities; the railroad companies retain a perpetual easement over these areas. They also retain a perpetual easement over such areas as are necessary for the maintenance and operation of all railroad facilities on lands colored yellow to be conveyed to the State by quit-claim deed; such areas to extend not less than twelve feet from the center line of each track measured on the level of the base of rail, with right to maintain slopes in cut or fill as the conditions may require.

PARCEL NO.	GRANTOR	GRANTEE	KIND OF INSTRUMENT	DATE OF INSTRUMENT	REMARKS
2	JAMES RUTHERFORD, ET UX	R. H. R. & T. CO.	DEED	8-27-1864	
4	JAMES S. VAN PELT, ET UX	DO	DO	6-13-1866	O. R. B. P. 306
5	DAVID H. MOUNT, ET UX	DO	DO	12-14-1864	O. R. B. P. 308
6	THEO. F. STOKER	DO	DO	12-17-1869	O. R. B. P. 310
21	ISAAC STORY, ET UX	C. & A. R. & T. CO.	DO	8-3-1840	
100	MATTHEW VAN DYKE, ET UX	D. & R. C. CO.	DO	1-27-1832	
101	ISAAC STORY, ET UX	DO	DO	1-16-1832	
102	JOHN SKILLMAN	DO	DO	4-11-1832	
103	ELIJAH STOUT, ET AL, EARS	DO	DO	3-26-1835	
104	PETER VAN TILBURGH, ET UX	DO	DO	8-18-1835	
105	JACOB GULICK, ET UX	DO	DO	5-28-1835	
106	ROBERT BAYLES	DO	DO	3-29-1831	
107	MARY BERRIEN, ET AL	DO	DO	5-12-1835	
108	DAVID COMFORT	DO	DO	4-5-1833	
109	WILLIAM CRUSER, ET UX	DO	DO	1-4-1841	

PARCEL NO.	GRANTOR	GRANTEE	KIND OF INSTRUMENT	DATE OF INSTRUMENT	REMARKS
110	JOHN CASPER	D. & R. C. CO.	DEED	8-28-1832	
113	HENRY PERKINS, ET UX	DO	DO	7-8-1834	INCLUDES FEET FROM DEED PART TO Canal Co. 3-16-1871
114	JACOB VAN DYKE	DO	DO		NO RECORD
318	WILLIAM J. VAN DYKE, ET UX	DO	DO	1836	Recorded AUG 27, 1836
319	DO	DO	DO	1-15-1840	
321	EVELINE VAN TILBURGH	DO	DO	1-9-1854	
322	CHARLES B. MOORE, ET AL	DO	DO	3-17-1871	
323	MARY WATSON	DO	DO	10-10-1839	
329	SAMUEL VAN TILBURGH	UN. J. R. & C. CO.	DO	6-26-1877	
344	CHARLES STINES, ET UX	DO	DO	8-15-1882	O. R. 15 P. 182
349	RICHARD S. CONOVER	UN. J. R. & C. CO.	DO	5-19-1832	

No. 47500
 MAP SHOWING DELAWARE AND RARITAN
 CANAL AND FEEDER IN THE
 STATE OF NEW JERSEY.
 AS OF JUNE 12, 1934.
 SCALE: 1" = 400' JUNE 1, 1932. REV. SEPT. 15, 1934.

OFFICE OF CHIEF ENGINEER, NEW YORK ZONE, P. R. R.
 PENNSYLVANIA STATION, NEW YORK, N. Y.

SHEET
 C-8

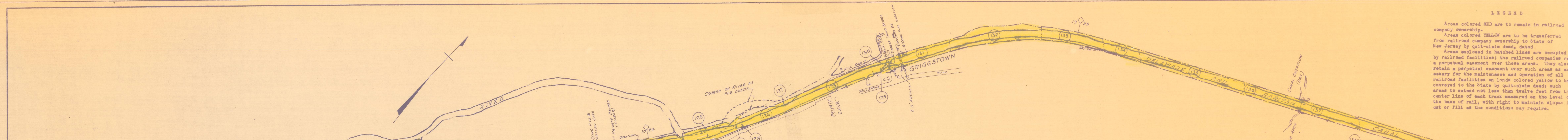

LEGEND

Areas colored RED are to remain in railroad company ownership.
 Areas colored YELLOW are to be transferred from railroad company ownership to State of New Jersey by quit-claim deed, dated
 Areas enclosed in hatched lines are occupied by railroad facilities; the railroad companies retain a perpetual easement over those areas as are necessary for the maintenance and operation of all railroad facilities on lands colored yellow to be conveyed to the State by quit-claim deed; such areas to extend not less than twelve feet from the center line of each track measured on the level of the base of rail, with right to maintain slopes in cut or fill as the conditions may require.

PARCEL No	GRANTOR	GRANTEE	KIND OR INSTRUMENT	DATE OF INSTRUMENT	REMARKS
114	JACOB VAN DYKE	D & R C CO			NO RECORD
115	WILLIAM CORTLEYOU, ET UX	DO	DEED	3-31-1832	
116	MARY HARTWELL, ET AL	DO	CONDEMN.	6-16-1835	
117	PETER W HOAGLAND, ET UX	DO	DEED	5-1-1832	
118	PHILIP BAKER, ET UX	DO	DO	5-2-1832	
119	JOHN VAN DOREN, ET AL	DO	DO	4-22-1833	EDS OF DEED OF ABRAHAM VAN DAREN DEED
120	JACOB VAN DIKE	DO	DO	8-3-1835	
121	JAMES B ELMENDORF, ET UX	DO	DO	3-29-1833	
123	CHRISTOPHER HOAGLAND	DO	DO	10-3-1834	
124	ISAAC GULICK, ET UX	DO	DO	2-4-1833	
125	GARRIT VAN DERVEER	DO	DO	12-18-1833	
126	JAMES B ELMENDORF, ET UX	DO	DO	3-29-1833	
127					NO RECORD
128	CORNELIUS TERHUNE	DO	DO	3-28-1831	
129	ABRAHAM C. BECKMAN, ET UX	DO	DO	1-31-1834	
130	CORNELIUS TERHUNE	DO	DO	3-28-1831	
131	CORNELIUS SIMONSON	DO	DO	3-27-1833	
132	JACOB GULICK, ET UX	DO	DO	3-29-1833	
133	PETER GULICK, ET UX	DO	DO	3-18-1833	
134	ABRAHAM PERLEE, ET UX	DO	DO	3-18-1833	
135	NICHOLAS VEGHTE	DO	CONDEMN	6-16-1835	
136	HENRY VEGHTE, ET UX	DO	DEED	4-30-1833	
137	ABRAHAM VEGHTE, ET UX	DO	DO	3-28-1831	
137 1/2	NICHOLAS VEGHTE	DO	CONDEMN	12-12-1834	RECORDED 6-16-1835
138	GARRET VEGHTE, ET UX	DO	DEED	1-14-1835	
139	JOHN GARRETSON, ET UX	DO	DO	4-28-1832	

No. 47500.
 MAP SHOWING DELAWARE AND RARITAN CANAL AND FEEDER IN THE STATE OF NEW JERSEY.
 AS OF JUNE 12, 1934.
 SCALE: 1" = 400' JUNE 1, 1932. REV. SEPT. 15, 1934.

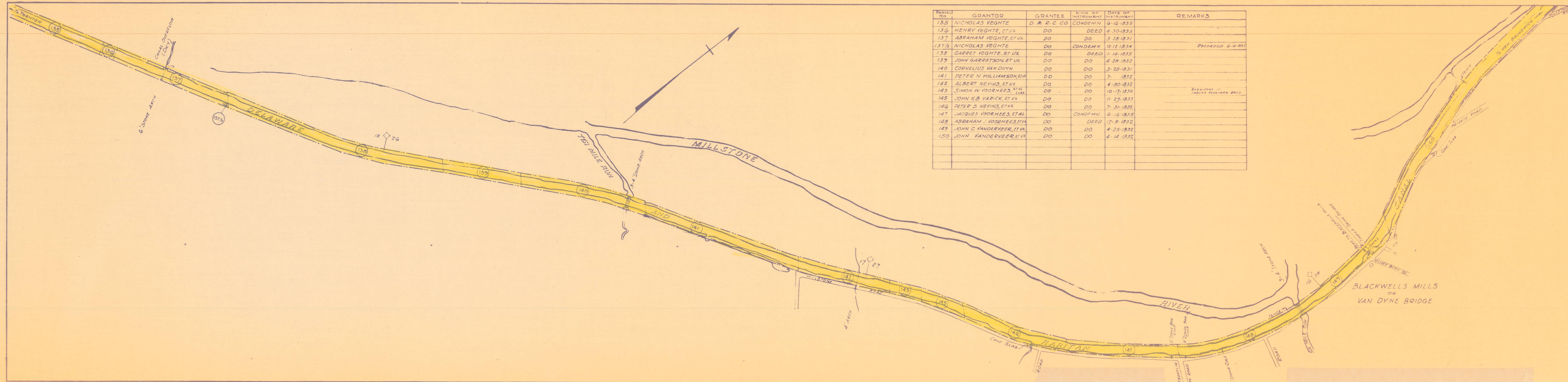

PARCEL NO.	GRANTOR	GRANTEE	KIND OF INSTRUMENT	DATE OF INSTRUMENT	REMARKS
135	NICHOLAS VEGHTE	D. & R. C. CO	CONDEMN	6-16-1835	
136	HENRY VEGHTE, ET UX	DO	DEED	4-30-1833	
137	ABRAHAM VEGHTE, ET UX	DO	DO	3-28-1831	
137 1/2	NICHOLAS VEGHTE	DO	CONDEMN	12-12-1834	RECORDED G-2-1835
138	GARRET VEGHTE, ET UX	DO	DEED	1-14-1835	
139	JOHN GARRETSON, ET UX	DO	DO	4-24-1832	
140	CORNELIUS VAN DUYN	DO	DO	3-28-1831	
141	PETER N WILLIAMSON, ET UX	DO	DO	7- 1832	
142	ALBERT NEVIUS, ET UX	DO	DO	4-30-1832	
143	SIMON W VOORHEES, ET AL	DO	DO	10-17-1834	EXECUTORS OF JACQUES VOORHEES DEED
145	JOHN V. B. VARICK, ET UX	DO	DO	11-29-1833	
146	PETER S NEVINS, ET UX	DO	DO	7- 31-1832	
147	JACQUES VOORHEES, ET AL	DO	CONDEMN.	6-16-1835	
148	ABRAHAM J. VOORHEES, ET UX	DO	DEED	12-8-1832	
149	JOHN G VANDERVEER, ET UX	DO	DO	4-25-1832	
150	JOHN VANDERVEER, ET UX	DO	DO	4-14-1832	

LEGEND

Areas colored RED are to remain in railroad company ownership.

Areas colored YELLOW are to be transferred from railroad company ownership to State of New Jersey by quit-claim deed, dated

Areas enclosed in hatched lines are occupied by railroad facilities; the railroad companies retain a perpetual easement over these areas. They also retain a perpetual easement over such areas as are necessary for the maintenance and operation of all railroad facilities on lands colored yellow to be conveyed to the State by quit-claim deed; such areas to extend not less than twelve feet from the center line of each track measured on the level of the base of rail, with right to maintain slopes in cut or fill as the conditions may require.

No. 47500.

MAP SHOWING DELAWARE AND RARITAN CANAL AND FEEDER IN THE STATE OF NEW JERSEY.

AS OF JUNE 12, 1934.

SCALE: 1" = 400' JUNE 1, 1932. REV. SEPT. 15, 1934

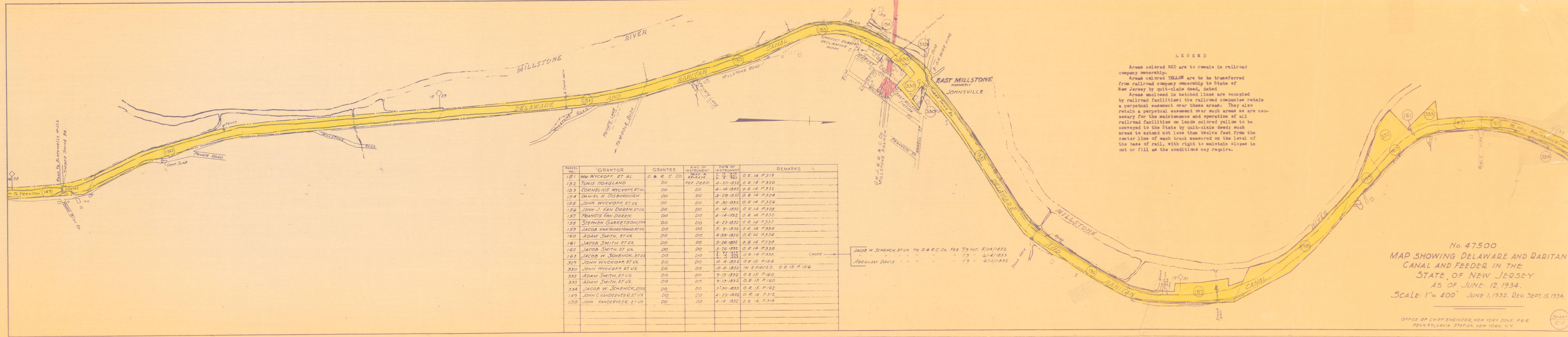

LEGEND

Areas colored RED are to remain in railroad company ownership.

Areas colored YELLOW are to be transferred from railroad company ownership to State of New Jersey by quit-claim deed, dated _____.

Areas enclosed in hatched lines are occupied by railroad facilities; the railroad companies retain a perpetual easement over these areas. They also retain a perpetual easement over such areas as are necessary for the maintenance and operation of all railroad facilities on lands colored yellow to be conveyed to the State by quit-claim deed; such areas to extend not less than twelve feet from the center line of each track measured on the level of the base of rail, with right to maintain slopes in cut or fill as the conditions may require.

PARCEL NO.	GRANTOR	GRANTEE	KIND OF INSTRUMENT	DATE OF INSTRUMENT	REMARKS
151	WM. WYCKOFF, ET AL	D. & R. C. CO.	DEED & RELEASE	4-14-1832	O. R. 14 P. 319
152	TUNIS HOAGLAND	DO	FEE DEED	4-20-1832	O. R. 14 P. 320
153	CORNELIUS WYCKOFF, ET AL	DO	DO	4-14-1832	O. R. 14 P. 322
154	DANIEL H. DISBOROUGH	DO	DO	3-28-1832	O. R. 14 P. 324
155	JOHN WYCKOFF, ET UX	DO	DO	4-30-1832	O. R. 14 P. 326
156	JOHN J. VAN DOREN, ET UX	DO	DO	4-14-1832	O. R. 14 P. 328
157	FRANCIS VAN DOREN	DO	DO	4-14-1832	O. R. 14 P. 330
158	STEPHEN GARRETSON, ET UX	DO	DO	4-23-1832	O. R. 14 P. 332
159	JACOB VAN MOORESTRAND, ET UX	DO	DO	5-9-1832	O. R. 14 P. 334
160	ADAM SMITH, ET UX	DO	DO	4-30-1832	O. R. 14 P. 336
161	JACOB SMITH, ET UX	DO	DO	5-26-1832	O. R. 14 P. 338
162	JACOB SMITH, ET UX	DO	DO	5-26-1832	O. R. 14 P. 338
163	JACOB W. SCHENCK, ET UX	DO	DO	7-14-1832	O. R. 14 P. 338
329	JOHN WYCKOFF, ET UX	DO	DO	10-4-1832	O. R. 15 P. 156
330	JOHN WYCKOFF, ET UX	DO	DO	10-4-1832	IN 2 PIECES O. R. 15 P. 156
332	ADAM SMITH, ET UX	DO	DO	9-13-1832	O. R. 15 P. 160
333	ADAM SMITH, ET UX	DO	DO	9-13-1832	O. R. 15 P. 160
334	JACOB W. SCHENCK, ET UX	DO	DO	3-30-1833	O. R. 15 P. 162
149	JOHN VANDERVEER, ET UX	DO	DO	4-25-1832	O. R. 14 P. 312
150	JOHN VANDERVEER, ET UX	DO	DO	4-14-1832	O. R. 14 P. 314

(NOTE)

JACOB W. SCHENCK, ET UX TO D. & R. C. CO. FEB. 7/9 INT. 5/24/1832

ABRAHAM DAVIS " " " " " 1/3 " 6/14/1833

ABRAHAM DAVIS " " " " " 1/9 " 6/12/1832

No. 47500

MAP SHOWING DELAWARE AND RARITAN CANAL AND FEEDER IN THE STATE OF NEW JERSEY AS OF JUNE 12, 1934.

SCALE: 1" = 400' JUNE 1, 1932. REV. SEPT. 15, 1934.

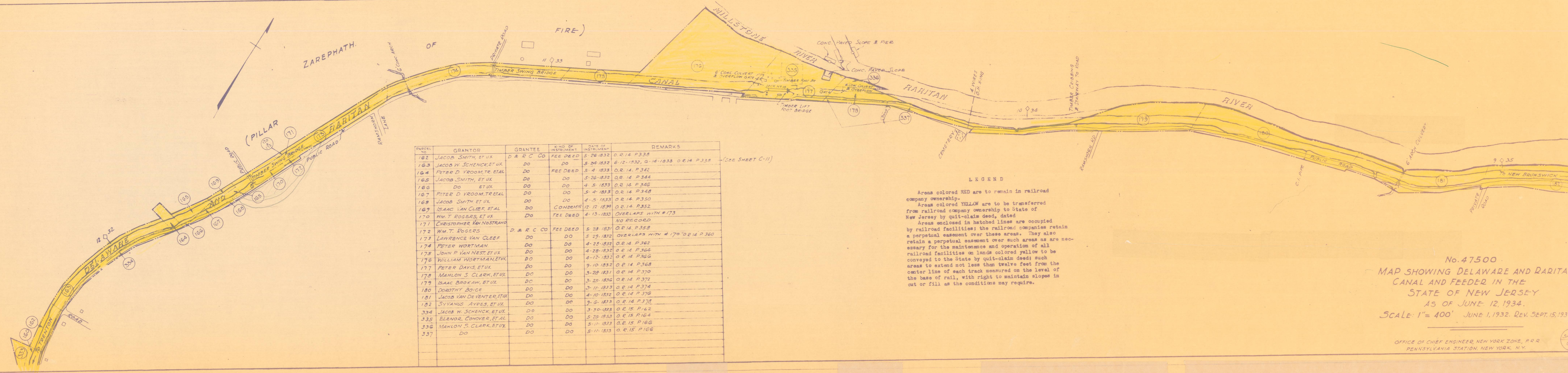

PARCEL NO.	GRANTOR	GRANTEE	KIND OF INSTRUMENT	DATE OF INSTRUMENT	REMARKS
162	JACOB SMITH, ET UX	D & R C CO	FEE DEED	5-26-1832	O.R. 14 P. 338
163	JACOB W. SCHENCK, ET UX	DO	DO	5-24-1832	6-12-1832, G-14-1833 O.R. 14 P. 338 (SEE SHEET C-11)
164	PETER D. VROOM, TR. ET AL	DO	FEE DEED	5-4-1833	O.R. 14 P. 342
165	JACOB SMITH, ET UX	DO	DO	5-26-1832	O.R. 14 P. 344
166	DO ET UX	DO	DO	4-5-1833	O.R. 14 P. 346
167	PETER D. VROOM, TR. ET AL	DO	DO	5-4-1833	O.R. 14 P. 348
168	JACOB SMITH ET UX	DO	DO	4-5-1833	O.R. 14 P. 350
169	ISAAC VAN CLEEF, ET AL	DO	CONDEMN	12-12-1839	O.R. 14 P. 352
170	WM. T. ROGERS, ET UX	DO	FEE DEED	4-13-1833	OVERLAPS WITH #173
171	CHRISTOPHER VAN NOSTRAND	DO	DO	DO	NO RECORD
172	WM. T. ROGERS	D & R C CO	FEE DEED	5-28-1831	O.R. 14 P. 358
173	LAWRENCE VAN CLEEF	DO	DO	5-29-1832	OVERLAPS WITH #170 O.R. 14 P. 360
174	PETER WORTMAN	DO	DO	4-28-1832	O.R. 14 P. 362
175	JOHN P. VAN NEST, ET UX	DO	DO	4-28-1832	O.R. 14 P. 364
176	WILLIAM WORTMAN, ET UX	DO	DO	4-12-1832	O.R. 14 P. 366
177	PETER DAVIS, ET UX	DO	DO	9-10-1832	O.R. 14 P. 368
178	MAHLON S. CLARK, ET UX	DO	DO	3-28-1831	O.R. 14 P. 370
179	ISAAC BROKAW, ET UX	DO	DO	3-25-1836	O.R. 14 P. 372
180	DOROTHY BOICE	DO	DO	3-11-1833	O.R. 14 P. 374
181	JACOB VAN DEVENTER, ET UX	DO	DO	4-10-1832	O.R. 14 P. 376
182	SYVANUS AYRES, ET UX	DO	DO	9-6-1833	O.R. 14 P. 378
334	JACOB W. SCHENCK, ET UX	DO	DO	3-30-1833	O.R. 15 P. 162
335	ELENOR CONOVER, ET AL	DO	DO	5-25-1853	O.R. 15 P. 164
336	MAHLON S. CLARK, ET UX	DO	DO	5-11-1833	O.R. 15 P. 166
337	DO	DO	DO	5-11-1833	O.R. 15 P. 166

LEGEND

Areas colored RED are to remain in railroad company ownership.

Areas colored YELLOW are to be transferred from railroad company ownership to State of New Jersey by quit-claim deed, dated _____

Areas enclosed in hatched lines are occupied by railroad facilities; the railroad companies retain a perpetual easement over these areas. They also retain a perpetual easement over such areas as are necessary for the maintenance and operation of all railroad facilities on lands colored yellow to be conveyed to the State by quit-claim deed; such areas to extend not less than twelve feet from the center line of each track measured on the level of the base of rail, with right to maintain slopes in cut or fill as the conditions may require.

No. 47500
 MAP SHOWING DELAWARE AND RARITAN CANAL AND FEEDER IN THE STATE OF NEW JERSEY AS OF JUNE 12, 1934.
 SCALE: 1" = 400' JUNE 1, 1932. REV. SEPT. 15, 1934.

OFFICE OF CHIEF ENGINEER, NEW YORK ZONE, P. R. R. PENNSYLVANIA STATION, NEW YORK, N. Y.

SHEET C-12

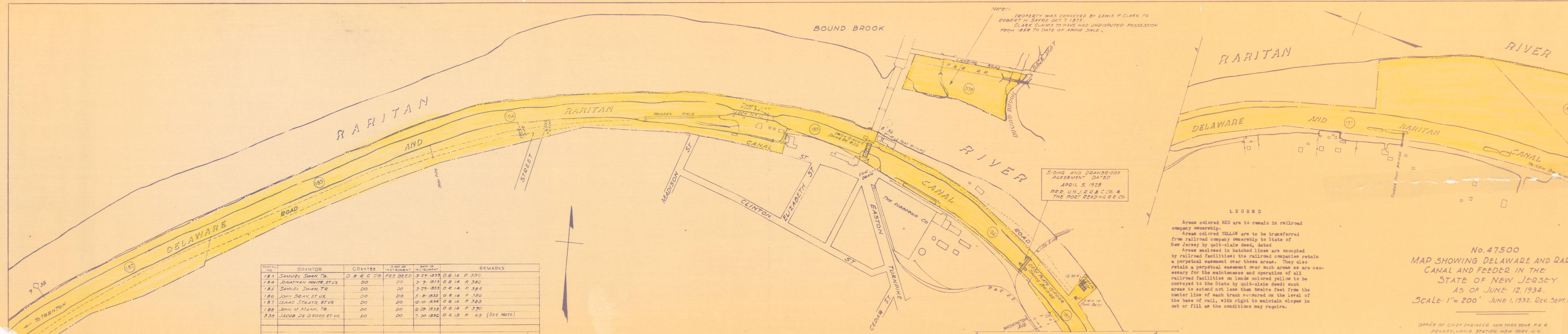

NOTE:-
 PROPERTY WAS CONVEYED BY LEWIS P. CLARK TO
 ROBERT H. SAYRE OCT. 7, 1872.
 CLARK CLAIMS TO HAVE HAD UNDISPUTED POSSESSION
 FROM 1858 TO DATE OF ABOVE SALE.

SIDING AND DRAWBRIDGE
 AGREEMENT DATED
 APRIL 5, 1928
 P. R. R., U. N. J. R. R. & C. CO. &
 THE PORT READING R. R. CO.

LEGEND
 Areas colored RED are to remain in railroad
 company ownership.
 Areas colored YELLOW are to be transferred
 from railroad company ownership to State of
 New Jersey by quit-claim deed, dated
 June 12, 1934.
 Areas enclosed in hatched lines are occupied
 by railroad facilities; the railroad companies retain
 a perpetual easement over these areas. They also
 retain a perpetual easement over such areas as are nec-
 essary for the maintenance and operation of all
 railroad facilities on lands colored yellow to be
 conveyed to the State by quit-claim deed; such
 areas to extend not less than twelve feet from the
 center line of each track measured on the level of
 the base of rail, with right to maintain slopes in
 cut or fill as the conditions may require.

PARCEL NO.	GRANTOR	GRANTEE	KIND OF INSTRUMENT	DATE OF INSTRUMENT	REMARKS
183	SAMUEL SWAN, TR.	D & R C CO.	FEE DEED	3-29-1833	O. R. 14 P. 380
184	JONATHAN WHITE, ET UX.	DO	DO	3-9-1833	O. R. 14 P. 382
185	SAMUEL SWAN, TR.	DO	DO	3-29-1833	O. R. 14 P. 384
186	JOHN BRAY, ET UX.	DO	DO	5-8-1832	O. R. 14 P. 386
187	ISAAC STAATS, ET UX.	DO	DO	12-10-1834	O. R. 14 P. 388
188	JOHN M. MANN, TR.	DO	DO	6-28-1833	O. R. 14 P. 390
338	JACOB DE GROOT, ET UX.	DO	DO	7-20-1836	O. R. 15 P. 68 (SEE NOTE)

No. 47500
 MAP SHOWING DELAWARE AND RARITAN
 CANAL AND FEEDER IN THE
 STATE OF NEW JERSEY.
 AS OF JUNE 12, 1934.
 SCALE: 1" = 200' JUNE 1, 1932. REV. SEPT. 15, 1934.

OFFICE OF CHIEF ENGINEER, NEW YORK ZONE P. R. R.
 PENNSYLVANIA STATION, NEW YORK, N. Y.

SHEET
 C-13

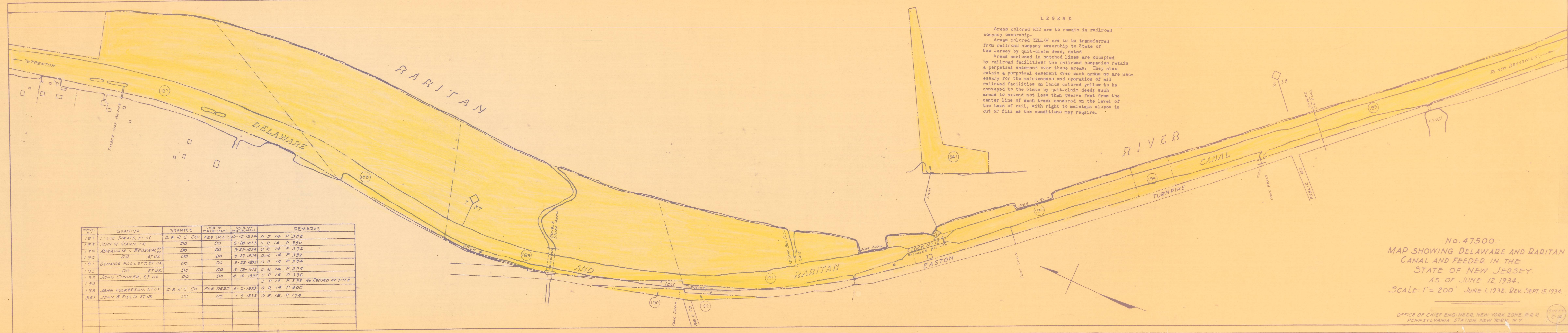

LEGEND

Areas colored RED are to remain in railroad company ownership.

Areas colored YELLOW are to be transferred from railroad company ownership to State of New Jersey by quit-claim deed, dated

Areas enclosed in hatched lines are occupied by railroad facilities; the railroad companies retain a perpetual easement over these areas. They also retain a perpetual easement over such areas as are necessary for the maintenance and operation of all railroad facilities on lands colored yellow to be conveyed to the State by quit-claim deed; such areas to extend not less than twelve feet from the center line of each track measured on the level of the base of rail, with right to maintain slopes in cut or fill as the conditions may require.

PARCEL NO.	GRANTOR	GRANTEE	KIND OF INSTRUMENT	DATE OF INSTRUMENT	REMARKS
187	L. H. STRATS, ET UX	D. & R. C. CO.	FEE DEED	12-10-1834	O. R. 14. P. 388
188	JOHN M. MANN, TR	DO	DO	6-28-1833	O. R. 14. P. 390
189	ABRAHAM I. BROKAW, JR	DO	DO	9-27-1834	O. R. 14. P. 392
190	DO ET UX	DO	DO	9-27-1834	O. R. 14. P. 392
191	GEORGE FOLLETT, ET UX	DO	DO	3-23-1832	O. R. 14. P. 394
192	DO ET UX	DO	DO	3-23-1832	O. R. 14. P. 394
193	JOHN CONOVER, ET UX	DO	DO	4-15-1835	O. R. 14. P. 396
194	DO	DO	DO	DO	O. R. 14. P. 398 No Record of Title
195	JOHN FULKERSON, ET UX	D. & R. C. CO.	FEE DEED	4-2-1833	O. R. 14. P. 400
341	JOHN B. FIELD ET UX	DO	DO	3-9-1833	O. R. 15. P. 174

No. 47500.

MAP SHOWING DELAWARE AND RARITAN CANAL AND FEEDER IN THE STATE OF NEW JERSEY.

AS OF JUNE 12, 1934.

SCALE: 1" = 200' JUNE 1, 1932. REV. SEPT. 15, 1934.

OFFICE OF CHIEF ENGINEER, NEW YORK ZONE, P. & R. PENNSYLVANIA STATION, NEW YORK, N. Y.

SHEET C-14

RARITAN

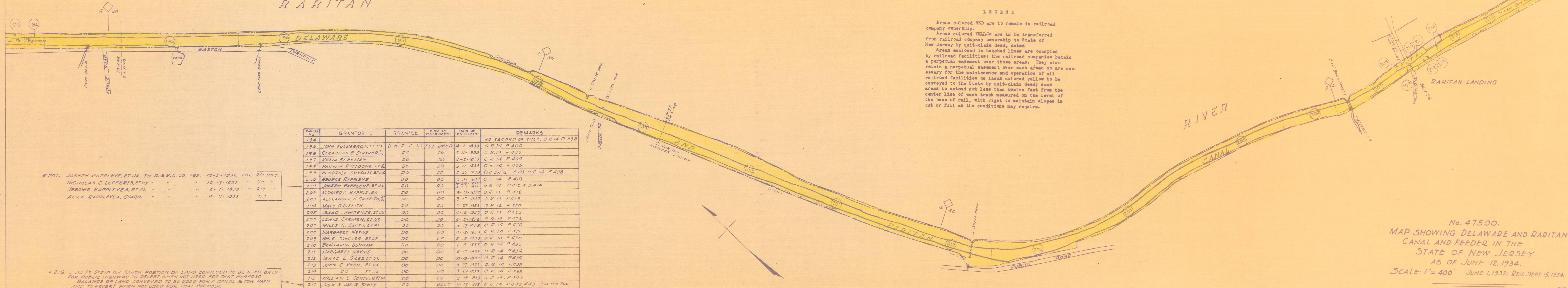

LEGEND

Areas colored RED are to remain in railroad company ownership.

Areas colored YELLOW are to be transferred from railroad company ownership to State of New Jersey by quit-claim deed, dated _____

Areas enclosed in hatched lines are occupied by railroad facilities; the railroad companies retain a perpetual easement over these areas. They also retain a perpetual easement over such areas as are necessary for the maintenance and operation of all railroad facilities on lands colored yellow to be conveyed to the State by quit-claim deed; such areas to extend not less than twelve feet from the center line of each track measured on the level of the base of rail, with right to maintain slopes in cut or fill as the conditions may require.

PARCEL NO.	GRANTOR	GRANTEE	KIND OF INSTRUMENT	DATE OF INSTRUMENT	REMARKS
194					NO RECORD OF TITLE. O.R. 14 P. 378
195	JOHN FULKERSON, ET UX.	D. R. C. CO.	FEE DEED	4-2-1833	O.R. 14 P. 400
196	GERARDUS B. STRYKER, ET UX.	DO	DO	4-15-1833	O.R. 14 P. 402
197	KEZIA BECKMAN	DO	DO	4-2-1833	O.R. 14 P. 404
198	HANNYAH RATTOONE, EXR.	DO	DO	6-11-1833	O.R. 14 P. 406
199	HENDRICK SUYDAM, ET UX.	DO	DO	2-26-1833	RFC BK 'Q' P. 123 O.R. 14 P. 408
200	GEORGE RAPPLEYE	DO	DO	12-31-1832	O.R. 14 P. 410
201	JOSEPH RAPPLEYE, ET UX.	DO	DO	10-5-1832 & 1-11-1833	O.R. 14 P. 412, 413, 414
202	RICHARD C. RAPPLEYE	DO	DO	9-17-1832	O.R. 14 P. 416
203	ALEXANDER H. GRIFFITH, ET UX.	DO	DO	9-17-1832	O.R. 14 P. 418
204	MARY GRIFFITH	DO	DO	2-27-1833	O.R. 14 P. 420
205	ISAAC LAWRENCE, ET UX.	DO	DO	1-16-1833	O.R. 14 P. 422
206	LEWIS CARMEN, ET UX.	DO	DO	4-2-1833	O.R. 14 P. 424
207	MILES C. SMITH, ET AL.	DO	DO	8-17-1833	O.R. 14 P. 426
208	MARGARET NEVIUS	DO	DO	4-12-1833	O.R. 14 P. 428
209	WM. E. CONOVER, ET UX.	DO	DO	2-18-1833	O.R. 14 P. 430
210	BENJAMIN DUNHAM	DO	DO	1-4-1833	O.R. 14 P. 432
211	MARGARET NEVIUS	DO	DO	4-12-1833	O.R. 14 P. 434
212	ISAAC E. GILES, ET UX.	DO	DO	10-13-1832	O.R. 14 P. 436
213	JOHN C. KOCH, ET UX.	DO	DO	3-27-1833	O.R. 14 P. 438
214	DO ET UX.	DO	DO	3-27-1833	O.R. 14 P. 438
215	WILLIAM E. CONOVER, ET UX.	DO	DO	2-18-1833	O.R. 14 P. 440
216	JOS. W. & JOS. G. SCOTT	DO	DEED	11-19-1832	O.R. 14 P. 442, 443. (LIMITED FEE)

201. JOSEPH RAPPLEYE, ET UX. TO D. & R. C. CO. FEE. 10-5-1832, FOR 2/7 INTS.
 NICHOLAS C. LEFFERTS, ET UX. " " 10-19-1832 " 1/7 "
 JEROME RAPPLEYE & ETAL " " 4-1-1833 " 2/7 "
 ALICE RAPPLEYE, GUARD. " " 4-11-1833 " 2/7 "

216. 33 FT STRIP ON SOUTH PORTION OF LAND CONVEYED TO BE USED ONLY FOR PUBLIC HIGHWAY TO REVERT WHEN NOT USED FOR THAT PURPOSE. BALANCE OF LAND CONVEYED TO BE USED FOR A CANAL & TOW PATH AND TO REVERT WHEN NOT USED FOR THAT PURPOSE.

No. 47500.
 MAP SHOWING DELAWARE AND RARITAN CANAL AND FEEDER IN THE STATE OF NEW JERSEY AS OF JUNE 12, 1934.
 SCALE: 1" = 400' JUNE 1, 1932. REV. SEPT. 15, 1934.

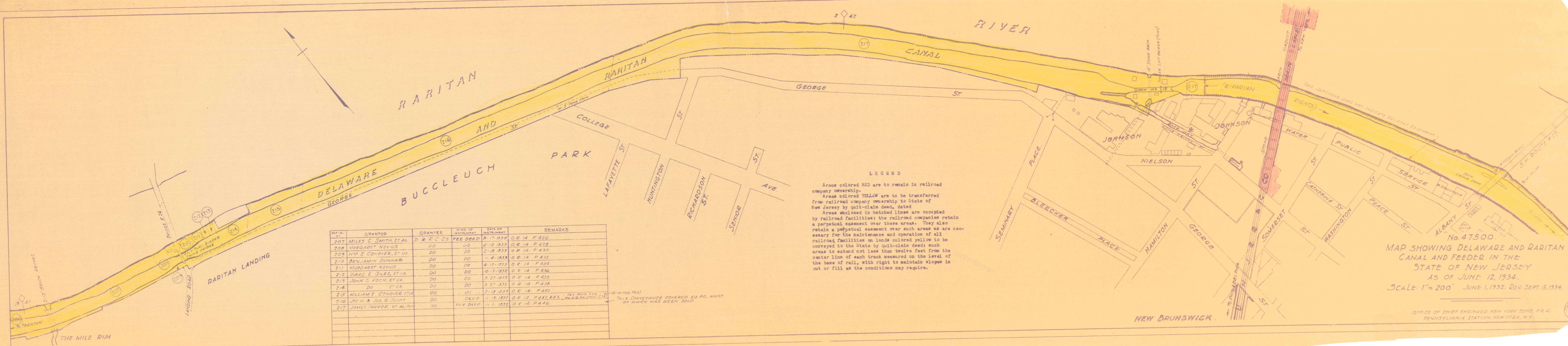

PARTIAL NO.	GRANTOR	GRANTEE	KIND OF INSTRUMENT	DATE OF INSTRUMENT	REMARKS
207	MILES G. SMITH ET AL.	D & R C CO	FEE DEED	8-17-1838	O R 14 P 426
208	MARGARET NEVIUS	DO	DO	4-12-1833	O R 14 P 428
209	W M E CONOVER, ET UX	DO	DO	2-18-1833	O R 14 P 430
210	BENJAMIN DUNHAM	DO	DO	1-4-1833	O R 14 P 432
211	MARGARET NEVIUS	DO	DO	4-12-1833	O R 14 P 434
212	ISAAC E GILES, ET UX	DO	DO	10-13-1832	O R 14 P 436
213	JOHN C KOCH, ET UX	DO	DO	3-27-1833	O R 14 P 438
214	DO ET UX	DO	DO	3-27-1833	O R 14 P 438
215	WILLIAM E CONOVER ET UX	DO	DO	2-18-1833	O R 14 P 440
216	JOS W & JOS G SCOTT	DO	DEED	11-19-1832	O R 14 P 442, 443, 444, 445, 446, 447, 448, 449, 450, 451, 452, 453, 454, 455, 456, 457, 458, 459, 460, 461, 462, 463, 464, 465, 466, 467, 468, 469, 470, 471, 472, 473, 474, 475, 476, 477, 478, 479, 480, 481, 482, 483, 484, 485, 486, 487, 488, 489, 490, 491, 492, 493, 494, 495, 496, 497, 498, 499, 500
217	JAMES PARKER, ET AL, ET UX	DO	FEE DEED	1-1-1832	O R 14 P 446

(LIMITED FEE)
THIS CONVEYANCE COVERED 50 AC. MOST OF WHICH HAS BEEN SOLD

LEGEND
 Areas colored RED are to remain in railroad company ownership.
 Areas colored YELLOW are to be transferred from railroad company ownership to State of New Jersey by quit-claim deed, dated
 Areas enclosed in hatched lines are occupied by railroad facilities; the railroad companies retain a perpetual easement over these areas. They also retain a perpetual easement over such areas as are necessary for the maintenance and operation of all railroad facilities on lands colored yellow to be conveyed to the State by quit-claim deed; such areas to extend not less than twelve feet from the center line of each track measured on the level of the base of rail, with right to maintain slopes in cut or fill as the conditions may require.

No. 47500.
 MAP SHOWING DELAWARE AND RARITAN CANAL AND FEEDER IN THE STATE OF NEW JERSEY AS OF JUNE 12, 1934.
 SCALE: 1" = 200' JUNE 1, 1932. REV. SEPT. 15, 1934.

OFFICE OF CHIEF ENGINEER, NEW YORK ZONE, P. R. 2. PENNSYLVANIA STATION, NEW YORK, N. Y.

SHEET C-16

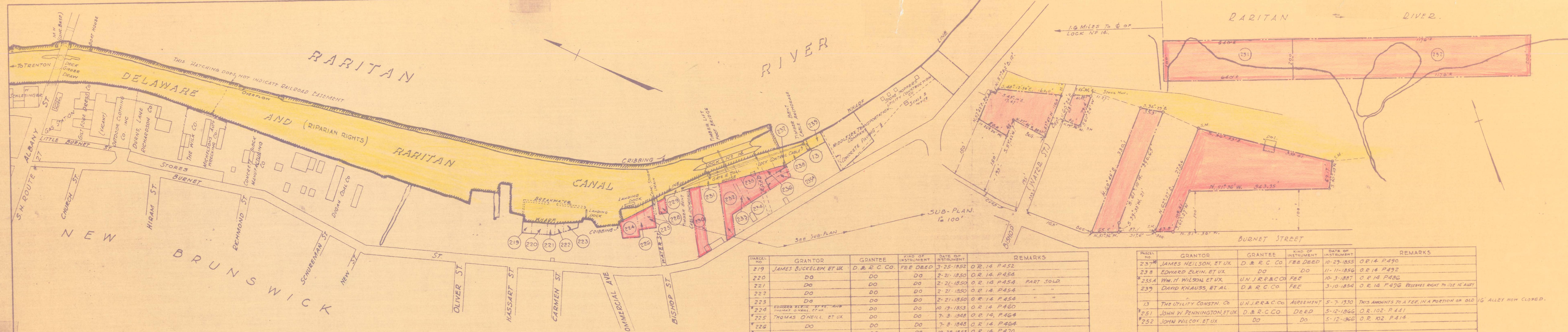

LEGEND

Areas colored RED are to remain in railroad company ownership.

Areas colored YELLOW are to be transferred from railroad company ownership to State of New Jersey by quit-claim deed, dated _____.

Areas enclosed in hatched lines are occupied by railroad facilities; the railroad companies retain a perpetual easement over these areas. They also retain a perpetual easement over such areas as are necessary for the maintenance and operation of all railroad facilities on lands colored yellow to be conveyed to the State by quit-claim deed; such areas to extend not less than twelve feet from the center line of each track measured on the level of the base of rail, with right to maintain slopes in cut or fill as the conditions may require.

PROPERTY OF THE D & R. C. CO. IN BAYONNE, N. J. IS RETAINED BY AGREEMENT WITH THE DEPARTMENT OF CONSERVATION AND DEVELOPMENT.

PARCEL NO.	GRANTOR	GRANTEE	KIND OF INSTRUMENT	DATE OF INSTRUMENT	REMARKS
219	JAMES BUCKELEM, ET UX	D. & R. C. CO.	FEE DEED	3-25-1852	O. R. 14. P. 452
220	DO	DO	DO	2-21-1850	O. R. 14. P. 454
221	DO	DO	DO	2-21-1850	O. R. 14. P. 454 PART SOLD
222	DO	DO	DO	2-21-1850	O. R. 14. P. 454
223	DO	DO	DO	2-21-1850	O. R. 14. P. 454
224	EDWARD BELIN, THOMAS O'NEILL, ET UX	DO	DO	10-19-1853	O. R. 14. P. 460
225	THOMAS O'NEILL, ET UX	DO	DO	7-8-1848	O. R. 14. P. 464
226	DO	DO	DO	7-8-1848	O. R. 14. P. 464
228	WILLIAM DEHART	DO	DO	10-28-1853	O. R. 14. P. 470
229	JAMES BUCKELEM, ET UX	DO	DO	11-9-1854	O. R. 14. P. 472
230	RICHARD S. CONOVER	U. N. J. R. R. & C. CO.	DO	5-13-1892	O. R. 15. P. 197 REC. 250 PG. 489
231	PATRICK NOLAN, ET UX	D. & R. C. CO.	DO	12-31-1851	O. R. 14. P. 476 RESERVES RIGHT TO CROSS OVER LAWS, CONVEYER, ETC.
232	JAMES BUCKELEM, ET UX	DO	DO	4-17-1848	O. R. 14. P. 480
233	JAMES NEILSON, ET UX	DO	DO	10-29-1855	O. R. 14. P. 483
234	PETER H. WENDOVER, ET UX	DO	DO	3-22-1833	O. R. 14. P. 484
235	JAMES NEILSON, ET UX	DO	DO	10-29-1855	O. R. 14. P. 486
236	EDWIN A. STEVENS	DO	DO	3-29-1833	O. R. 14. P. 488

PARCEL NO.	GRANTOR	GRANTEE	KIND OF INSTRUMENT	DATE OF INSTRUMENT	REMARKS
237	JAMES NEILSON, ET UX	D. & R. C. CO.	FEE DEED	10-29-1855	O. R. 14. P. 490
238	EDWARD ELKIN, ET UX	DO	DO	11-11-1856	O. R. 14. P. 492
235A	WM. H. WILSON, ET UX	U. N. J. R. R. & C. CO.	FEE	10-3-1887	O. R. 14. P. 486
239	DAVID KNAUSS, ET AL.	D. & R. C. CO.	FEE	3-10-1854	O. R. 14. P. 476 RESERVES RIGHT TO USE 16' ALLEY
13	THE UTILITY CONSTN. CO.	U. N. J. R. R. & C. CO.	AGREEMENT	5-7-1930	THIS AMOUNTS TO A FEE, IN A PORTION OF OLD 16' ALLEY NOW CLOSED.
251	JOHN W. PENNINGTON, ET UX	D. & R. C. CO.	DEED	5-12-1866	O. R. 102. P. 441
252	JOHN WILCOX, ET UX	DO	DO	5-12-1866	O. R. 102. P. 414

* THESE PARCELS, WHERE COLORED RED, ARE RETAINED BY AGREEMENT WITH DEPT. OF CONSERVATION AND DEVELOPMENT.

No. 47500.

MAP SHOWING DELAWARE AND RARITAN CANAL AND FEEDER IN THE STATE OF NEW JERSEY AS OF JUNE 12, 1934.

SCALE: 1" = 200' JUNE 1, 1932. REV. SEPT. 15, 1934.

OFFICE OF CHIEF ENGINEER, NEW YORK ZONE, P. R. R. PENNSYLVANIA STATION, NEW YORK, N. Y.

SHEET C-17

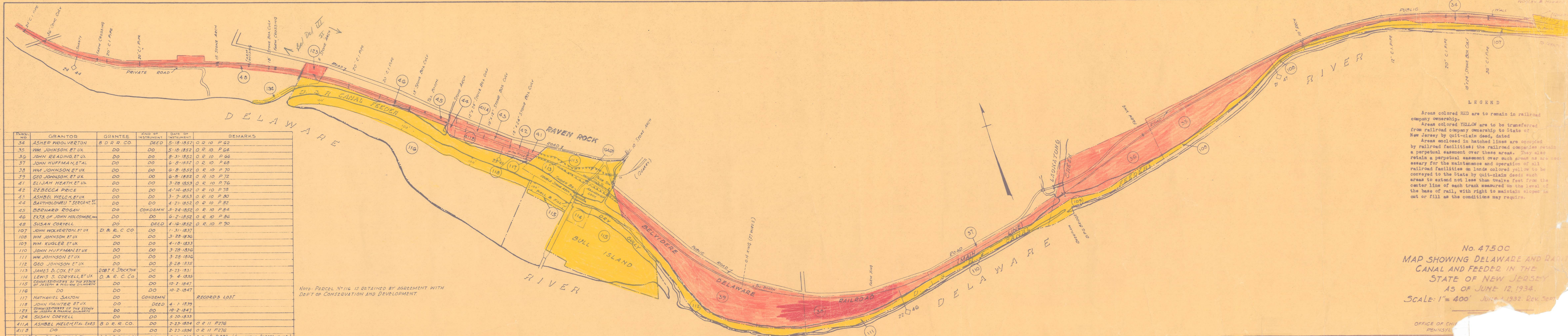

PARCEL NO.	GRANTOR	GRANTEE	KIND OF INSTRUMENT	DATE OF INSTRUMENT	REMARKS
34	ASHER WOOLVERTON	B D R R CO	DEED	5-18-1852	O R 10 P 62
35	WM JOHNSON, ET UX	DO	DO	5-18-1852	O R 10 P 64
36	JOHN READING, ET UX	DO	DO	8-31-1852	O R 10 P 66
37	JOHN HUFFMAN, ET AL	DO	DO	6-8-1852	O R 10 P 68
38	WM JOHNSON, ET UX	DO	DO	6-8-1852	O R 10 P 70
39	GEO JOHNSON, ET UX	DO	DO	6-8-1852	O R 10 P 72
41	ELIJAH HEATH, ET UX	DO	DO	3-28-1853	O R 10 P 76
42	REBECCA PRICE	DO	DO	4-14-1852	O R 10 P 78
43	ASHBEL WELCH, ET UX	DO	DO	3-9-1853	O R 10 P 80
44	BARTHOLOMEU T SERGENT, ET UX	DO	DO	4-21-1852	O R 10 P 82
45	BERNARD ROGAN	DO	CONDEMN	5-24-1852	O R 10 P 84
46	EXRS OF JOHN HOLCOMBE, JR	DO	DO	6-2-1852	O R 10 P 86
48	SUSAN CORYELL	DO	DEED	4-16-1852	O R 10 P 90
107	JOHN WOOLVERTON, ET UX	D & R C CO	DO	1-31-1837	
108	WM JOHNSON, ET UX	DO	DO	3-28-1836	
109	WM KUGLER, ET UX	DO	DO	4-18-1833	
110	JOHN HUFFMAN, ET UX	DO	DO	3-28-1836	
111	WM JOHNSON, ET UX	DO	DO	3-28-1836	
112	GEO JOHNSON, ET UX	DO	DO	3-28-1835	
113	JAMES B COX, ET UX	ROBT F STOCKTON	DC	8-23-1831	
114	LEWIS S CORYELLE, ET UX	D & R C CO	DO	9-4-1835	
115	COMMISSIONERS OF THE ESTATE OF JOSEPH & WILLIAM DILWORTH	DO	DO	10-2-1847	
116	DO	DO	DO	10-2-1847	
117	NATHANIEL SANJON	DO	CONDEMN		RECORDS LOST
118	JOHN PAINTER, ET UX	DO	DEED	4-1-1839	
123	COMMISSIONERS OF THE ESTATE OF JOSEPH & WILLIAM DILWORTH	DO	DO	10-2-1847	
124	SUSAN CORYELL	DO	DO	5-20-1833	
411A	ASHBEL WELCH, ET AL EXRS	B D R R CO	DO	2-23-1834	O R 11 P 276
411B	DO	DO	DO	2-23-1834	O R 11 P 276
16469	BAYARD STOCKTON, TR	UNJ R R & C CO	DO	5-6-1902	O R 15 P 383 (Lying within PARCEL # 113.)

NOTE: PARCEL #116 IS RETAINED BY AGREEMENT WITH DEPT OF CONSERVATION AND DEVELOPMENT.

LEGEND

Areas colored RED are to remain in railroad company ownership.

Areas colored YELLOW are to be transferred from railroad company ownership to State of New Jersey by quit-claim deed, dated _____.

Areas enclosed in hatched lines are occupied by railroad facilities; the railroad companies retain a perpetual easement over such areas as are necessary for the maintenance and operation of all railroad facilities on lands colored yellow to be conveyed to the State by quit-claim deed; such areas to extend not less than twelve feet from the center line of each track measured on the level of the base of rail, with right to maintain slopes in cut or fill as the conditions may require.

No. 4750C
 MAP SHOWING DELAWARE AND RARITAN CANAL AND FEEDER IN THE STATE OF NEW JERSEY AS OF JUNE 12, 1934.
 SCALE: 1" = 400' JUNE 1, 1932, REV. 5/31/34

OFFICE OF CHIEF ENGINEER
 PENNSYLVANIA RAILROAD COMPANY

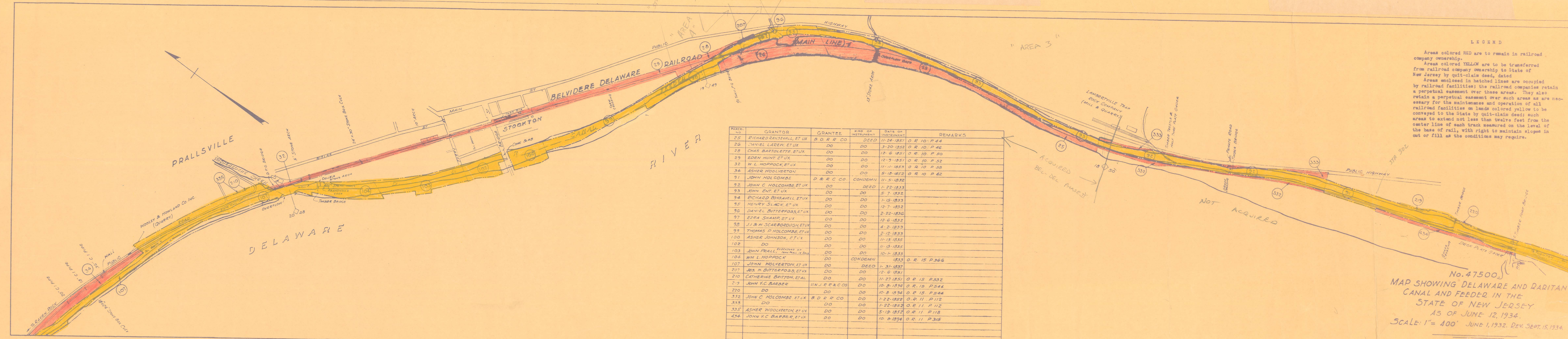

PARCEL NO.	GRANTOR	GRANTEE	KIND OF INSTRUMENT	DATE OF INSTRUMENT	REMARKS
25	RICHARD RANSSELL, ET UX	B D R R CO	DEED	11-24-1851	O R 10 P 44
26	DANIEL LAREW, ET UX	DO	DO	3-20-1852	O R 10 P 46
28	CHAS BARTOLETTE, ET UX	DO	DO	12-6-1851	O R 10 P 50
29	EDEN HUNT, ET UX	DO	DO	12-9-1851	O R 10 P 52
32	W. L. HOPPOCK, ET UX	DO	DO	11-11-1853	O R 10 P 58
34	ASHER WOOLVERTON	DO	DO	5-18-1852	O R 10 P 62
91	JOHN HOLCOMBE	D & R C CO.	CONDEMN	11-5-1832	
92	JOHN C. HOLCOMBE, ET UX	DO	DEED	1-22-1833	
93	JOHN ENT, ET UX	DO	DO	5-7-1832	
94	RICHARD RANSSELL, ET UX	DO	DO	1-15-1833	
95	HENRY SLACK, ET UX	DO	DO	12-7-1832	
96	DANIEL BUTTERFOSS, ET UX	DO	DO	2-22-1836	
97	EZRA SHAMP, ET UX	DO	DO	12-6-1832	
98	J. I. & W. SCARBOROUGH, ET UX	DO	DO	4-2-1833	
99	THOMAS P. HOLCOMBE, ET UX	DO	DO	2-12-1833	
100	ASHER JOHNSON, ET UX	DO	DO	11-13-1835	
102	DO	DO	DO	11-13-1835	
103	JOHN PRALL, Sections of John Prall's Deed	DO	DO	10-1-1833	
104	WM L. HOPPOCK	DO	CONDEMN	1833	O R 15 P 366
107	JOHN WOLVERTON, ET UX	DO	DEED	1-31-1837	
207	JOS. H. BUTTERFOSS, ET UX	DO	DO	12-6-1831	
210	CATHERINE BRITTON, ET AL	DO	DO	11-27-1851	O R 15 P 532
219	JOHN V. C. BARBER	UNJ R R & C CO	DO	10-8-1894	O R 15 P 544
220	DO	DO	DO	10-8-1894	O R 15 P 544
332	JOHN C. HOLCOMBE, ET UX	B D R R CO	DO	1-22-1852	O R 11 P 112
333	DO	DO	DO	1-22-1852	O R 11 P 112
335	ASHER WOOLVERTON, ET UX	DO	DO	5-18-1852	O R 11 P 118
434	JOHN V. C. BARBER, ET UX	DO	DO	10-8-1894	O R 11 P 315

LEGEND

Areas colored RED are to remain in railroad company ownership.

Areas colored YELLOW are to be transferred from railroad company ownership to State of New Jersey by quit-claim deed, dated _____.

Areas enclosed in hatched lines are occupied by railroad facilities; the railroad companies retain a perpetual easement over these areas. They also retain a perpetual easement over such areas as are necessary for the maintenance and operation of all railroad facilities on lands colored yellow to be conveyed to the State by quit-claim deed; such areas to extend not less than twelve feet from the center line of each track measured on the level of the base of rail, with right to maintain slopes in cut or fill as the conditions may require.

No. 47500
 MAP SHOWING DELAWARE AND RARITAN CANAL AND FEEDER IN THE STATE OF NEW JERSEY AS OF JUNE 12, 1934.
 SCALE: 1" = 400' JUNE 1, 1932. REV. SEPT. 15, 1934.

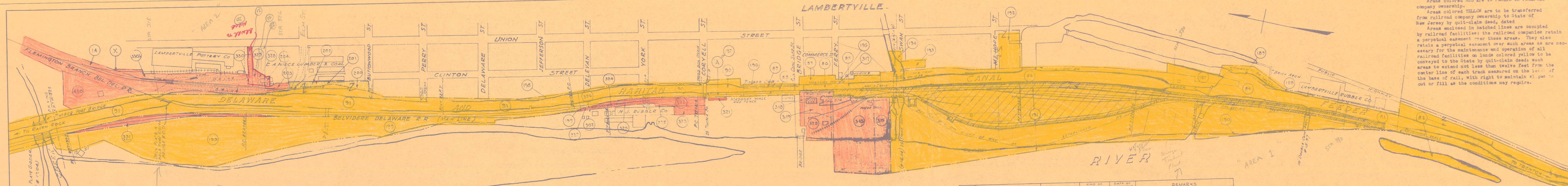

LEGEND

Area colored RED are to remain in railroad company ownership.
 Area colored YELLOW are to be transferred from railroad company ownership to State of New Jersey by quit-claim deed, dated
 Areas enclosed in hatched lines are occupied by railroad facilities; the railroad companies retain a perpetual easement over these areas. They also retain a perpetual easement over such areas as are necessary for the maintenance and operation of all railroad facilities on lands colored yellow to be conveyed to the State by quit-claim deed; such areas to extend not less than twelve feet from the center line of each track measured on the level of the base of rail, with right to maintain slope to cut or fill as the conditions may require.

Parcel No.	GRANTOR	GRANTEE	KIND OF INSTRUMENT	DATE OF INSTRUMENT	REMARKS
82	BENJAMIN PARRY, ET AL	D & R C CO	FEE DEED	4-28-1832	O. R. 15 P. 328
83	JNO. CORYELL	DO	DO	5-19-1842	O. R. 15 P. 330
84	EXEC. OF JNO WILSON	DO	DO	5-2-1846	O. R. 15 P. 331
85	EXEC. OF WM. BILES	DO	DO	2-12-1834	O. R. 15 P. 334
86	MAHON BRIGGS, ET UX	DO	DO	9-28-1832	O. R. 15 P. 336
87	EXEC. OF S. BLODGET	DO	DO	4-1-1833	O. R. 15 P. 338
88	WILLIAM HALL	DO	DO	5-3-1832	O. R. 15 P. 340
89	JOHN CHAMBERS, ET UX	DO	DO	7-2-1832	O. R. 15 P. 342
90	JOHN CORYELL	DO	DO	5-19-1842	O. R. 15 P. 344
91	JNO. HOLCOMBE	DO	CONDEMN	11-5-1810	O. R. 15 P. 346
187	EXEC. OF JNO. WILSON	DO	FEE DEED	5-20-1850	O. R. 15 P. 492 RIGHT RESERVED FOR TAIL RACE
188	DO	DO	DO	5-20-1850	O. R. 15 P. 492
189	L. R. TITUS ET UX	DO	DO	7-21-1857	O. R. 15 P. 494
190	EXEC. OF JNO WILSON	DO	DO	5-4-1847	O. R. 15 P. 496
190	MARY WILSON	D. & R. C. CO	RELEASE OF DOWER	11-28-1851	REC. DB. 101 P. 211 12-2-1851
191	EXEC. OF JNO WILSON	D. & R. C. CO	FEE DEED	5-20-1850	O. R. 15 P. 498

Parcel No.	GRANTOR	GRANTEE	KIND OF INSTRUMENT	DATE OF INSTRUMENT	REMARKS
191	MARY WILSON	D & R C CO	RELEASE OF DOWER	11-28-1851	REC. DB. 101 P. 211 12-2-1851
192	OLIVER PAXSON, ET UX	D & R C CO	FEE DEED	3-30-1867	O. R. 15 P. 500
193	WILLIAM MCCREARY, ET UX	DO	DO	3-9-1869	O. R. 15 P. 502
194	LAMBERTVILLE WATER POWER	DO	DO	1-1-1857	O. R. 15 P. 504
196	T. B. CARR, ET UX	DO	DO	5-29-1852	O. R. 15 P. 508
199	T. B. CARR, ET UX	DO	DO	5-5-1857	O. R. 15 P. 514
200	J. T. HULL, ET UX	DO	DO	4-26-1864	O. R. 15 P. 518
201	JOHN H. ANDERSON, ET UX	DO	DO	11-15-1864	O. R. 15 P. 520
202	WILLIAM JOHNSON, ET UX	DO	DO	6-9-1840	O. R. 15 P. 521
203	THOMAS B. CARR, ET UX	DO	DO	12-2-1867	O. R. 15 P. 522
204	C. ARNETT, ET UX	DO	DO	4-15-1870	O. R. 15 P. 523
315	THOMAS FINLEY, ET AL	BEL DEL R. R.	DO	2-27-1874	O. R. 11 P. 74 BX 432 P. 7
316	OLIVER PARRY, ET AL. TRS	DO	DO	6-12-1850	O. R. 11 P. 78 BX 432 P. 7
317	JAMES SEABROOK, ET UX	DO	DO	4-1-1850	O. R. 11 P. 82
318	W. B. MONTGOMERY, ET UX	DO	DO	11-6-1863	O. R. 11 P. 84
319	EDWARD VANUXEM, ET UX	DO	DO	11-6-1863	O. R. 11 P. 86 BX 432 P. 7
320	DO	DO	DO	3-18-1864	O. R. 11 P. 88 BX 432 P. 7
321	HORATIO N. BEAUMONT	DO	DO	1-20-1852	O. R. 11 P. 90
322	JNO. CORYELL	DO	DO	10-5-1850	O. R. 11 P. 92
323	FRIDGET WICKHAM	DO	DO	7-4-1850	O. R. 11 P. 94

Parcel No.	GRANTOR	GRANTEE	KIND OF INSTRUMENT	DATE OF INSTRUMENT	REMARKS
324	JNO CORYELL	BEL DEL R. R.	FEE DEED	11-26-1851	O. R. 11 P. 96
325	DO	DO	DO	10-26-1853	O. R. 11 P. 98
326	GEORGE A. KONL	DO	DO	6-18-1851	O. R. 11 P. 100
327	DO	DO	DO	5-23-1857	O. R. 11 P. 102
328	JOHN MULLALLY, ET UX	DO	DO	5-14-1873	O. R. 11 P. 104
329	CATHERINE MASTERTON	DO	DO	5-14-1873	O. R. 11 P. 106
330	ANN WEDDEN & WM. H. GANDEY	DO	DO	2-19-1873	O. R. 11 P. 108 BX 432 P. 8
330	GEORGE ALLEN, ET AL	DO	DO	5-27-1873	O. R. 11 P. 107
331	JNO. HOLCOMBE, EST	DO	CONDEMN	4-22-1852	O. R. 11 P. 110 BX 432 P. 8
430	STEPHEN W. VAN HORNE, ET UX	DO	FEE DEED	10-16-1891	O. R. 11 P. 309 BX 434 P. 1
430	V. J. RUBBER CO	DO	DO	3-4-1918	BK 325 P. 340 & 10-19-18 BOX 2313 P. 4
502	V. J. RUBBER CO	FLEMINGTON R. R. CO	CONDEMN	1-10-1854	O. R. 20 P. 20
1A	CAROLINE HOLCOMB, ET UX	D. & R. C. CO	FEE DEED	11-4-1833	O. R. 15 P. 510
195	ROBT. ELY, ET UX	DO	DO	4-26-1867	O. R. 15 P. 506
198	JOHN SILVERP, ET UX	DO	DO	5-1-1857	O. R. 15 P. 512
X	ANDREW FOLTZ, ET UX	BEL DEL R. R.	DO	8-27-1920	BK 2454 P. 2

Note *These parcels are retained by agreement with Dept of Conservation and Development.

No. 47500.
 MAP SHOWING DELAWARE AND RARITAN CANAL AND FEEDER IN THE STATE OF NEW JERSEY.
 AS OF JUNE 12, 1934.
 SCALE: 1" = 200' JUNE 1, 1932. REV. SEPT. 15, 1934.

OFFICE OF CHIEF ENGINEER, NEW YORK ZONE, P. R. R. PENNSYLVANIA STATION, NEW YORK, N. Y.

SHEET F-3

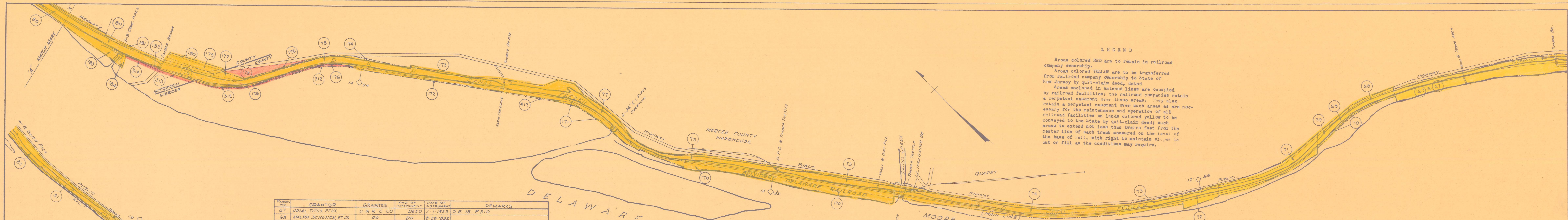

LEGEND

Areas colored RED are to remain in railroad company ownership.

Areas colored YELLOW are to be transferred from railroad company ownership to State of New Jersey by quit-claim deed, dated _____.

Areas enclosed in hatched lines are occupied by railroad facilities; the railroad companies retain a perpetual easement over these areas. They also retain a perpetual easement over such areas as are necessary for the maintenance and operation of all railroad facilities on lands colored yellow to be conveyed to the State by quit-claim deed; such areas to extend not less than twelve feet from the center line of each track measured from the level of the base of rail, with right to maintain slope in cut or fill as the conditions may require.

Parcel No.	GRANTOR	GRANTEE	KIND OF INSTRUMENT	DATE OF INSTRUMENT	REMARKS
67	URIAL TITUS, ET UX	D & R C CO	DEED	2-1-1833	O. R. 15. P. 310
68	RALPH SCHENCK, ET UX	DO	DO	8-28-1832	
69	AARON PIDCOCK	DO	DO	8-28-1832	
70	JOS TITUS, ET AL	DO	DO	3-3-1835	
71	JOHN FARLY	DO	DO	8-28-1832	
73	URIAL TITUS, ET UX	DO	DO	2-1-1833	
74	AMOS MOORE, ET UX	DO	DO	5-1-1833	
75	JANE FISHER	DO	DO	4-27-1833	
77	GEORGE LARASON, ET UX	DO	DO	5-1-1833	
78	ANDREW D. W. STOUT, ET UX	DO	DO	6-1-1833	
79	THOMAS PIDCOCK, ET UX	DO	DO	5-1-1833	
80	ANDREW D. W. STOUT, ET UX	DO	DO	6-1-1833	
81	BENJAMIN PARRY, ET AL	DO	DO	4-28-1832	
82	DO	DO	DO	4-28-1832	
169	BENJ W TITUS, ET AL	DO	DO	6-30-1853	O. R. 15. P. 468
170	JONATHAN STOUT, ET UX	DO	DO	12-31-1853	
171	CORNELIA BLARASON, ET AL	DO	DO	5-13-1858	O. R. 15. P. 472
172	DO	DO	DO	5-13-1858	DO
173	DO	DO	DO	5-13-1858	DO
174	DO	DO	DO	5-13-1858	DO

Parcel No.	GRANTOR	GRANTEE	KIND OF INSTRUMENT	DATE OF INSTRUMENT	REMARKS
175	CORNELIA B. LARASON, ET AL	D. & R. C. CO	DEED	5-13-1858	O. R. 15. P. 472
176	DO	DO	DO	5-13-1858	DO
177	ASHER EGE, ET UX	DO	DO	1-19-1864	O. R. 15. P. 476
178	ASHER EGE, ET UX	UNJ R & CO	DO	9-24-1874	O. R. 15. P. 478
179	CHARLES MERSHON, ET UX	D. & R. C. CO	DO	10-2-1850	
180	DO	DO	DO	11-9-1865	
181	ASHER EGE, ET AL	DO	DO	5-13-1858	
182	ASHER EGE, ET AL	DO	DO	5-13-1858	
183	ISRAEL HERRING, ADOR ** EST. OF A. D. N. STOUT	DO	DO	12-18-1835	
184	ASHER EGE, ET AL	DO	DO	5-13-1858	
312	ASHER EGE	B. D. R. C. CO	DO	4-11-1874	
313	RALPH ASHTON, ET UX	DO	DO	4-11-1874	O. R. 11. P. 70
314	ASHER EGE, ET UX	DO	DO	4-11-1874	O. R. 11. P. 72
417	RICHARD SKUHL, SPECIAL MASTER	DO	DO	3-7-1887	O. R. 11. P. 285
72	ANN MOORE, ET AL	D. & R. C. CO	DO	10-10-1833	

No. 47500
 MAP SHOWING DELAWARE AND RARITAN
 CANAL AND FEEDER IN THE
 STATE OF NEW JERSEY.
 AS OF JUNE 12, 1934.
 SCALE: 1" = 400' JUNE 1, 1932. REV. SEPT. 15, 1934.

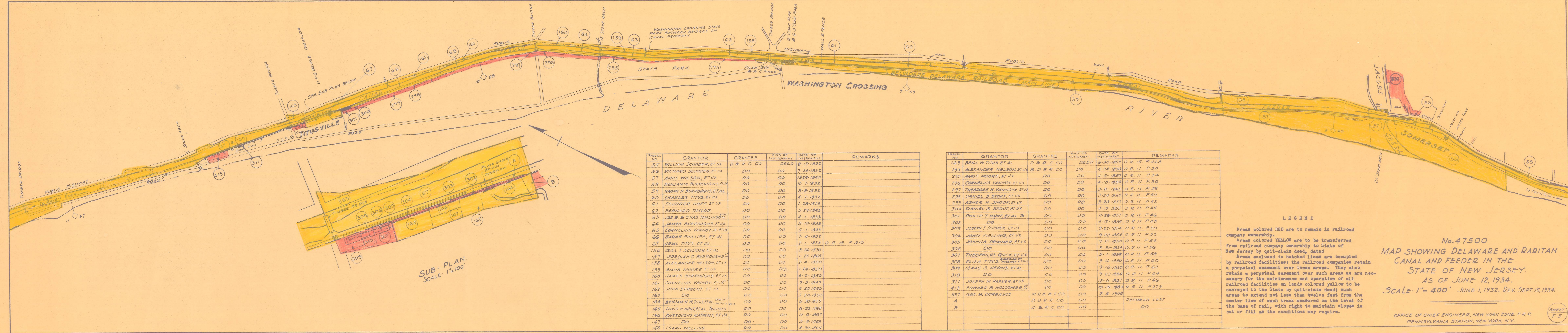

PARCEL NO.	GRANTOR	GRANTEE	KIND OF INSTRUMENT	DATE OF INSTRUMENT	REMARKS
55	WILLIAM SCUDDER, ET UX	D & R C CO	DEED	8-13-1832	
56	RICHARD SCUDDER, ET UX	DO	DO	7-24-1832	
57	AMOS WILSON, ET UX	DO	DO	12-24-1840	
58	BENJAMIN BURROUGHS, ET UX	DO	DO	12-7-1832	
59	NAOMI H BURROUGHS, ET AL	DO	DO	8-8-1832	
60	CHARLES TITUS, ET UX	DO	DO	4-7-1832	
61	SCUDDER HOFF, ET UX	DO	DO	1-28-1833	
62	BERNARD TAYLOR	DO	DO	5-29-1843	
63	JOS. B. & CHAS TOMLINSON	DO	DO	4-1-1833	
64	JAMES BURROUGHS, ET UX	DO	DO	5-10-1833	
65	CORNELIUS VANNOY, JR ET UX	DO	DO	5-1-1833	
66	SARAH PHILLIPS, ET AL	DO	DO	7-4-1832	
67	URIEL TITUS, ET UX	DO	DO	2-1-1833	O. R. 15 P. 310
156	URIEL T. SCUDDER, ET AL	DO	DO	8-26-1870	
157	JEREDIAH D BURROUGHS	DO	DO	1-25-1865	
158	ALEXANDER NELSON, ET UX	DO	DO	2-4-1850	
159	AMOS MOORE ET UX	DO	DO	1-24-1850	
160	JAMES BURROUGHS, ET UX	DO	DO	4-2-1850	
161	CORNELIUS VANNOY, ET UX	DO	DO	9-5-1849	
162	JOHN SERGENT, ET UX	DO	DO	5-20-1850	
163	DO	DO	DO	5-20-1850	
164	BENJAMIN W. TITUS, ET AL	DO	DO	6-30-1859	
165	DAVID H. HUNT, ET AL TRUSTEES	DO	DO	6-26-1868	
166	BURROUGHS MATHENS, ET UX	DO	DO	12-6-1867	
167	DO	DO	DO	5-8-1868	
168	ISAAC WELING	DO	DO	4-30-1864	

PARCEL NO.	GRANTOR	GRANTEE	KIND OF INSTRUMENT	DATE OF INSTRUMENT	REMARKS
169	BENJ. W. TITUS, ET AL	D & R C CO	DEED	6-30-1859	O. R. 15 P. 468
293	ALEXANDER NELSON, ET UX	B. D. R. R. CO	DO	4-24-1850	O. R. 11 P. 30
295	AMOS MOORE, ET UX	DO	DO	4-5-1850	O. R. 11 P. 34
296	CORNELIUS VANNOY, ET UX	DO	DO	4-10-1850	O. R. 11 P. 36
297	THEODORE H. VANNOY, ET UX	DO	DO	3-8-1865	O. R. 11 P. 38
298	DANIEL S. STOUT, ET UX	DO	DO	3-24-1850	O. R. 11 P. 40
299	ASHER H. SNOOK, ET UX	DO	DO	3-28-1857	O. R. 11 P. 42
300	DANIEL S. STOUT, ET UX	DO	DO	4-3-1855	O. R. 11 P. 44
301	PHILIP T. HUNT, ET AL TR.	DO	DO	11-28-1857	O. R. 11 P. 46
302	DO	DO	DO	4-12-1854	O. R. 11 P. 48
303	JOSEPH T. SCUDDER, ET UX	DO	DO	9-22-1854	O. R. 11 P. 50
304	JOHN WELING, ET UX	DO	DO	9-22-1854	O. R. 11 P. 52
305	JOSHUA PRIMMER, ET UX	DO	DO	9-21-1850	O. R. 11 P. 54
306	DO	DO	DO	3-31-1859	O. R. 11 P. 56
307	THEOPHILUS QUICK, ET UX	DO	DO	5-1-1859	O. R. 11 P. 58
308	ELIZA TITUS, MARGARET A. TITUS	DO	DO	9-16-1850	O. R. 11 P. 60
309	ISAAC S. NEWINS, ET AL	DO	DO	9-16-1850	O. R. 11 P. 62
310	DO	DO	DO	9-22-1854	O. R. 11 P. 64
311	JOSEPH H. PARKER, ET UX	DO	DO	12-6-1867	O. R. 11 P. 66
413	EDWARD B. HOGCOMBE, ET UX	DO	DO	10-15-1883	O. R. 11 P. 279
537	GEO. M. DORRANCE	M. R. & F. CO	DO	2-5-1906	
A		B. D. R. R. CO	DO		RECORDS LOST
B		D. & R. C. CO	DO		DO

LEGEND

Areas colored RED are to remain in railroad company ownership.

Areas colored YELLOW are to be transferred from railroad company ownership to State of New Jersey by quit-claim deed, dated _____

Areas enclosed in hatched lines are occupied by railroad facilities; the railroad companies retain a perpetual easement over these areas. They also retain a perpetual easement over such areas as are necessary for the maintenance and operation of all railroad facilities on lands colored yellow to be conveyed to the State by quit-claim deed; such areas to extend not less than twelve feet from the center line of each track measured on the level of the base of rail, with right to maintain slopes in cut or fill as the conditions may require.

No. 47500
 MAP SHOWING DELAWARE AND RARITAN CANAL AND FEEDER IN THE STATE OF NEW JERSEY.
 AS OF JUNE 12, 1934.
 SCALE: 1" = 400' JUNE 1, 1932. REV. SEPT. 15, 1934.

OFFICE OF CHIEF ENGINEER, NEW YORK ZONE, P. R. R. PENNSYLVANIA STATION, NEW YORK, N. Y.

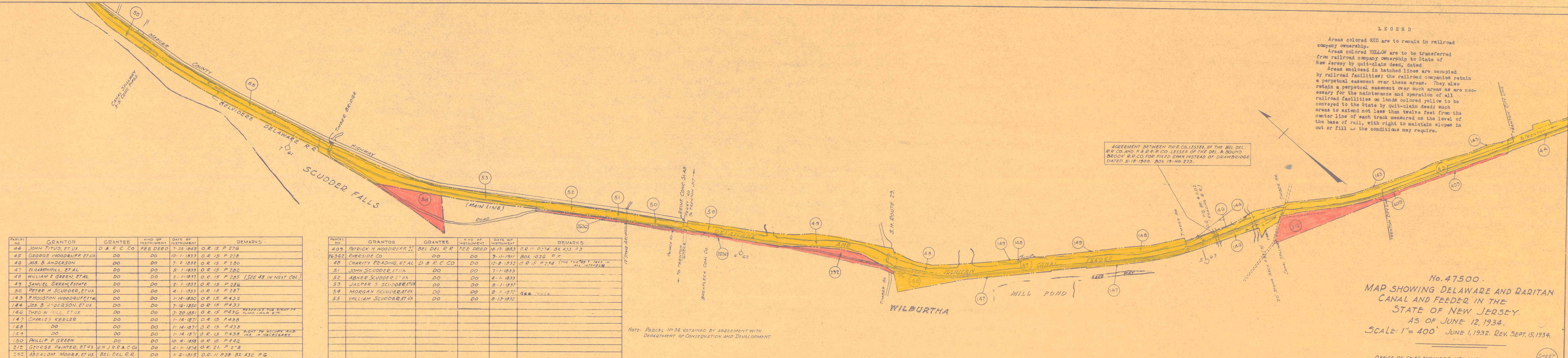

LEGEND

Areas colored RED are to remain in railroad company ownership.

Areas colored YELLOW are to be transferred from railroad company ownership to State of New Jersey by quit-claim deed, dated _____.

Areas enclosed in hatched lines are occupied by railroad facilities; the railroad companies retain a perpetual easement over these areas. They also retain a perpetual easement over such areas as are necessary for the maintenance and operation of all railroad facilities on lands colored yellow to be conveyed to the State by quit-claim deed; such areas to extend not less than twelve feet from the center line of each track measured on the level of the base of rail, with right to maintain slopes in cut or fill as the conditions may require.

AGREEMENT BETWEEN P.P. CO. LESSEE OF THE BEL DEL R.R. CO. AND P. & R.R. CO. LESSEE OF THE DEL. & BOUND BROOK R.R. CO. FOR FIXED SPAN INSTEAD OF DRAWBRIDGE DATED 5-18-1900. BOX 19-NO 223.

PARCEL NO.	GRANTOR	GRANTEE	KIND OF INSTRUMENT	DATE OF INSTRUMENT	REMARKS
44	JOHN TITUS, ET UX	D & R C CO	FEE DEED	7-25-1842	O.R. 15, P. 276
45	GEORGE WOODRUFF, ET UX	DO	DO	10-1-1833	O.R. 15, P. 278
46	JOS. B. ANDERSON	DO	DO	7-2-1832	O.R. 15, P. 280
47	ELIZABETH HILL, ET AL	DO	DO	5-1-1833	O.R. 15, P. 282
48	WILLIAM E. GREEN, ET AL	DO	DO	7-1-1837	O.R. 15, P. 285 (SEE 48 IN NEXT COL.)
49	SAMUEL GREEN, ESTATE	DO	DO	2-1-1833	O.R. 15, P. 286
50	PETER H. SCUDDER, ET UX	DO	DO	4-1-1833	O.R. 15, P. 287
143	RHOUSTON WOODRUFF, ET AL	DO	DO	1-14-1850	O.R. 15, P. 432
144	JOS. B. ANDERSON, ET UX	DO	DO	7-16-1850	O.R. 15, P. 433
146	THEO. W. HILL, ET UX	DO	DO	3-20-1851	O.R. 15, P. 436 (RESERVES THE RIGHT TO ADD LAND, ETC.)
147	CHARLES KEELER	DO	DO	1-14-1871	O.R. 15, P. 438
148	DO	DO	DO	1-14-1871	O.R. 15, P. 438
149	DO	DO	DO	1-14-1871	O.R. 15, P. 438 (RIGHT TO OCCUPY AND USE, IF NECESSARY.)
150	PHILLIP P. GREEN	DO	DO	10-4-1858	O.R. 15, P. 442
212	GEORGE PAINTER, ET UX	U.N. J. R.R. & C. CO.	DO	4-1-1874	O.R. 21, P. 278
232	ASSALOM MOORE, ET UX	BEL. DEL. R.R.	DO	1-6-1855	O.R. 11, P. 28, BX-432, P.G.

PARCEL NO.	GRANTOR	GRANTEE	KIND OF INSTRUMENT	DATE OF INSTRUMENT	REMARKS
409	PATRICK H. WOODRUFF, ET UX	BEL. DEL. R.R.	FEE DEED	10-17-1833	O.R. 11, P. 274, BX 433, P. 3
26352	RIVERSIDE CO.	DO	DO	9-11-1911	BOX 1626, P. 5
40	CHARITY READING, ET AL	D & R C CO.	DO	12-8-1832	O.R. 15, P. 284 (THE TRACTS ARE IN ALL INTERESTS)
51	JOHN SCUDDER, ET UX	DO	DO	7-1-1833	
52	ABNER SCUDDER, ET UX	DO	DO	4-1-1833	
53	JASPER S. SCUDDER, ET UX	DO	DO	8-1-1837	
54	MORGAN SCUDDER, ET UX	DO	DO	8-1-1837	SEE NOTE
55	WILLIAM SCUDDER, ET UX	DO	DO	8-13-1832	

NOTE: PARCEL NO. 54 RETAINED BY AGREEMENT WITH DEPARTMENT OF CONSERVATION AND DEVELOPMENT.

No. 47500.
 MAP SHOWING DELAWARE AND RARITAN CANAL AND FEEDER IN THE STATE OF NEW JERSEY.
 AS OF JUNE 12, 1934.
 SCALE: 1" = 400' JUNE 1, 1932. REV. SEPT. 15, 1934.

OFFICE OF CHIEF ENGINEER, NEW YORK ZONE, P. R. R. PENNSYLVANIA STATION, NEW YORK, N.Y.

SHEET F-6

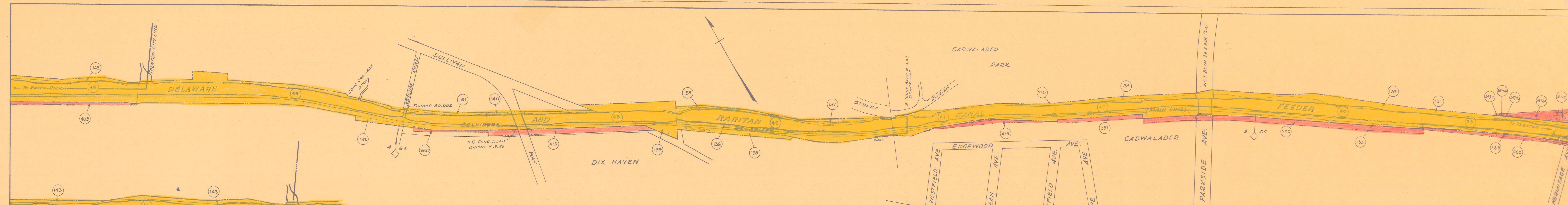

PARCEL NO.	GRANTOR	GRANTEE	KIND OF INSTRUMENT	DATE OF INSTRUMENT	REMARKS
39	SAMUEL DICKINSON, ET UX	D & R. C. CO.	FEE DEED	12-1-1832	O.R. 15 P. 262
40	THOMAS CADWALADER, ET UX	DO	DO	1-12-1835	REVERTS IF CANAL IS ABANDONED - O.R. 15 P. 264
41	SARAH DEAN, ET AL.	DO	DO	4-1-1833	O.R. 15 P. 266
42	RICHARD L. HOWELL, ET UX	DO	DO	5-31-1836	O.R. 15 P. 268
43	PHIBE HOWELL, ET AL.	DO	CONDEMN.	7-17-1833	CONDEMNATION. O.R. 15, P. 27. SEE NOTE
44	JOHN TITUS, ET UX	DO	FEE DEED	7-25-1842	O.R. 15 P. 276
45	GEORGE WOODRUFF, ET UX	DO	DO	10-1-1833	O.R. 15 P. 278
132	THOMAS CADWALADER, ET UX	DO	DO	10-2-1850	O.R. 15 P. 416
133	DO	DO	DO	10-2-1850	O.R. 15 P. 416
134	HENRY MCCALL	DO	DO	9-21-1849	O.R. 15 P. 418
135	THEODORE HOWELL, ET UX	DO	DO	9-10-1849	O.R. 15 P. 420. RES. WAGON RD. ACROSS LAND
136	JOHN G. LABAW, ET UX	DO	DO	6-10-1850	O.R. 15 P. 422
137	DO	DO	DO	6-10-1850	O.R. 15 P. 422
138	HORACE A. BUTTOLPH, ET UX	DO	DO	11-20-1867	O.R. 15 P. 424
139	HENRY W. DAVIS, ET UX	DO	DO	12-16-1867	O.R. 15 P. 426
140	MARY R. DAVIS, ET AL.	DO	FEE DEED	4-24-1850	O.R. 15 P. 428
141	AMBROSE W. ENGLISH, ET UX	DO	DO	10-1-1850	O.R. 15 P. 430. RESERVING SPRING & ROADWAY
142	DO	DO	DO	10-1-1850	O.R. 15 P. 430
143	P. HOUSTON WOODRUFF, ET UX	DO	DO	1-14-1850	O.R. 15 P. 432

PARCEL NO.	GRANTOR	GRANTEE	KIND OF INSTRUMENT	DATE OF INSTRUMENT	REMARKS
215	GEO. W. FARLER, ET UX	UN. J. R. & C. CO.	FEE DEED	4-6-1886	O.R. 15 P. 538
289	PHILEMON DICKINSON	BEL. DEL. R.R.	DO	3-25-1850	O.R. 11 P. 20. BK. 432. PG.
290	THOMAS CADWALADER	DO	DO	9-18-1873	O.R. 11 P. 22. BK. 432. PG.
291	HENRY MCCALL	DO	DO	8-30-1850	O.R. 11 P. 24. BK. 432. PG. RESERVING ROADWAY
408	EDWARD J. C. ATTERBURY	DO	DO	7-28-1883	O.R. 11 P. 273. P.R.C.O. TO BUILD FENCE & ROAD
409	PATRICK H. WOODRUFF	DO	DO	10-17-1883	O.R. 11 P. 274. BK. 433. P. 3. RESERVING ROADWAY
414	EDWIN COOK, ET AL.	DO	DO	2-15-1886	O.R. 11 P. 281
415	HORACE A. BUTTOLPH, ET UX	DO	DO	4-22-1886	O.R. 11 P. 282. BK. 433. P. 5
33624	CATHERINE FRANKFORD	W. B. R. J. FOREST	DO	6-21-1923	BK. 511. P. 423. 62873. BK. 2617. P. 5
34564	ADATH ISRAEL CONGREGAN.	BEL. DEL. R.R.	DO	6-21-1923	" 514. P. 424. " 21. 789. " 2617. P. 5
34703	CHAS. J. DOURESS	UN. J. R. & C. CO.	DO	10-25-1920	BOX 2534. P. 12
34704	CLARENCE H. BOND, ET UX	DO	DO	5-3-1926	BOX 2569. P. 11. BK. 504. P. 48
34713	PAULINE E. MILLER	DO	DO	5-3-1926	" 2569. P. 10. BK. 590. P. 180
36021	WALTER C. SLACK, ET UX	BEL. DEL. R.R.	DO	11-10-1926	" 2532. P. 16. Ch. Rec. 3. 598. P. 50
131	PHILEMON DICKINSON, ET UX	D. & E. C. CO.	DO	5-23-1929	REC. B. 649. P. 536. BK. 2404. P. 13
43	PHILEMON DICKINSON, ET UX	D. & E. C. CO.	DO	8-13-1849	O.R. 15 P. 414
43	PHIBE A. CHAMBERS	D. & R. C. CO.	FEE 'S INT.	10-10-1842	BK. 15. PG. 273
43	JOHN H. CHAMBERS	DO	DO	1-30-1847	BK. 15. PG. 273
43	MARY A. CHAMBERS	DO	DO	10-4-1851	BK. 15. PG. 274

LEGEND

Areas colored RED are to remain in railroad company ownership.

Areas colored YELLOW are to be transferred from railroad company ownership to State of New Jersey by quit-claim deed, dated _____.

Areas enclosed in hatched lines are occupied by railroad facilities; the railroad companies retain a perpetual easement over these areas. They also retain a perpetual easement over such areas as are necessary for the maintenance and operation of all railroad facilities on lands colored yellow to be conveyed to the State by quit-claim deed; such areas to extend not less than twelve feet from the center line of each track measured on the level of the base of rail, with right to maintain slopes in cut or fill as the conditions may require.

No. 47500
 MAP SHOWING DELAWARE AND RARITAN
 CANAL AND FEEDER IN THE
 STATE OF NEW JERSEY.
 AS OF JUNE 12, 1934.
 SCALE: 1" = 200' JUNE 1, 1932. REV. SEPT. 15, 1934.

OFFICE OF CHIEF ENGINEER, NEW YORK ZONE, P.R.R.
 PENNSYLVANIA STATION, NEW YORK, N.Y.

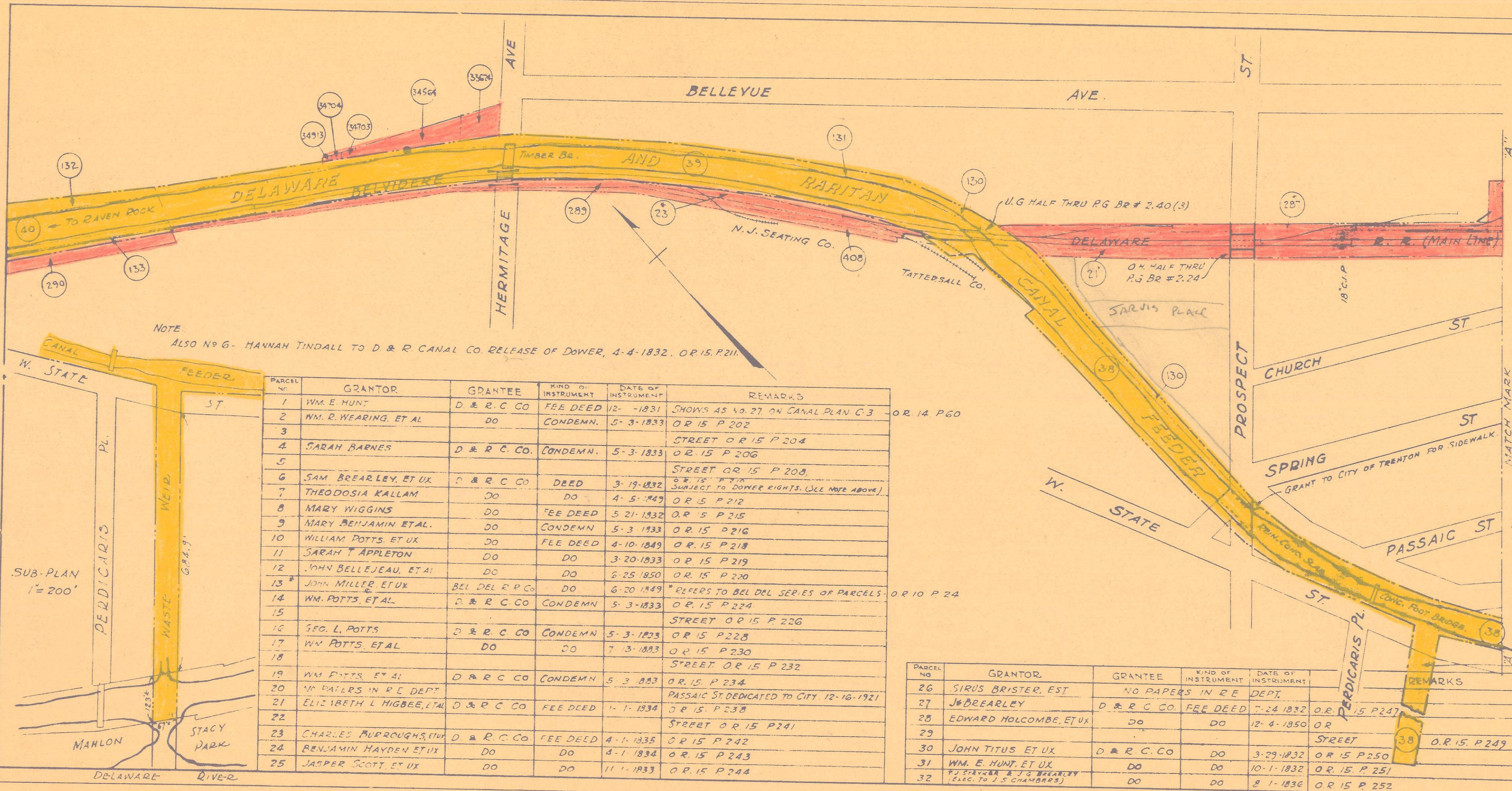

PARCEL NO.	GRANTOR	GRANTEE	KIND OF INSTRUMENT	DATE OF INSTRUMENT	REMARKS
1	WM. E. HUNT	D & R C CO	FEE DEED	12-1-1831	SHOWS AS NO. 27 ON CANAL PLAN C-3
2	WM. R. WEARING, ET AL	DO	CONDEMN.	5-3-1833	O.R. 15 P. 202
3	SARAH BARNES	D & R C CO	CONDEMN.	5-3-1833	STREET O.R. 15 P. 204
4	SARAH BARNES	D & R C CO	CONDEMN.	5-3-1833	O.R. 15 P. 206
5	SAM BREARLEY, ET UX	D & R C CO	DEED	3-19-1832	STREET O.R. 15 P. 208
6	THEODOSIA KALLAM	DO	DO	4-5-1849	O.R. 15 P. 212
7	MARY WIGGINS	DO	FEE DEED	5-21-1832	O.R. 15 P. 215
8	MARY BENJAMIN, ET AL.	DO	CONDEMN.	5-3-1833	O.R. 15 P. 216
9	WILLIAM POTTS, ET UX	DO	FEE DEED	4-10-1849	O.R. 15 P. 218
10	SARAH APPLETON	DO	DO	3-20-1833	O.R. 15 P. 219
11	JOHN BELLEJEAU, ET AL.	DO	DO	2-25-1850	O.R. 15 P. 220
12	JOHN MILLER, ET UX	BEL DEL RR CO	DO	6-20-1849	* REFERS TO BEL DEL SERIES OF PARCELS
13	WM. POTTS, ET AL.	D & R C CO	CONDEMN.	5-3-1833	O.R. 15 P. 224
14	WM. POTTS, ET AL.	D & R C CO	CONDEMN.	5-3-1833	O.R. 15 P. 226
15	WM. POTTS, ET AL.	D & R C CO	CONDEMN.	5-3-1833	O.R. 15 P. 228
16	WM. POTTS, ET AL.	D & R C CO	CONDEMN.	5-3-1833	O.R. 15 P. 230
17	WM. POTTS, ET AL.	D & R C CO	CONDEMN.	5-3-1833	O.R. 15 P. 232
18	WM. POTTS, ET AL.	D & R C CO	CONDEMN.	5-3-1833	O.R. 15 P. 234
19	WM. POTTS, ET AL.	D & R C CO	CONDEMN.	5-3-1833	O.R. 15 P. 236
20	WM. POTTS, ET AL.	D & R C CO	CONDEMN.	5-3-1833	O.R. 15 P. 238
21	ELIZABETH L. HIGBEE, ET AL.	D & R C CO	FEE DEED	1-1-1834	STREET O.R. 15 P. 241
22	CHARLES MURROUGHS, ET UX	D & R C CO	FEE DEED	4-1-1835	O.R. 15 P. 242
23	BENJAMIN HAYDEN, ET UX	DO	DO	4-1-1834	O.R. 15 P. 243
24	JASPER SCOTT, ET UX	DO	DO	11-1-1833	O.R. 15 P. 244

PARCEL NO.	GRANTOR	GRANTEE	KIND OF INSTRUMENT	DATE OF INSTRUMENT	REMARKS
26	SIRUS BRISTER, EST	NO PAPERS IN RE	DEPT.		
27	JOB BREARLEY	D & R C CO	FEE DEED	7-24-1832	O.R. 15 P. 247
28	EDWARD HOLCOMBE, ET UX	DO	DO	12-4-1850	O.R. 15 P. 249
29	JOHN TITUS, ET UX	D & R C CO	DO	3-29-1832	O.R. 15 P. 250
30	WM. E. HUNT, ET UX	DO	DO	10-1-1832	O.R. 15 P. 251
31	WM. E. HUNT, ET UX	DO	DO	8-1-1836	O.R. 15 P. 252

PARCEL NO.	GRANTOR	GRANTEE	KIND OF INSTRUMENT	DATE OF INSTRUMENT	REMARKS
3*	THEODORE SMITH	BEL DEL RR	FEE DEED	6-20-1849	O.R. 10 P. 8
126	T. KALLAM	D & R C CO	DO	8-2-1852	O.R. ORIGINAL PART OF II. SOLD & REPURCHASED O.R. 15 P. 218

PARCEL NO.	GRANTOR	GRANTEE	KIND OF INSTRUMENT	DATE OF INSTRUMENT	REMARKS	
33	PETER T. SMITH	D & R C CO	FEE DEED	12-24-1881	O.R. 15 P. 254	
34	JOHN MUSGROVE'S ESTATE	DO	DEED	10-16-1832	O.R. 15 P. 255	
35	MRS ANNA ARMSTRONG, ET AL.	DO	FEE DEED	7-1-1833	O.R. 15 P. 256	
36	ABIGAIL WOODRUFF, ET AL.	DO	DO	10-1-1833	O.R. 15 P. 257	
37	DAVID C. CLAYPOOLE, ET UX	DO	DO	5-29-1839	O.R. 15 P. 258	
38	MARY RUTHERFORD	DO	DEED	5-4-1846	REVERTS IF CANAL IS ABANDONED. O.R. 15 P. 259	
39	JAMUEL DICKINSON, ET UX	DO	FEE DEED	12-1-1832	O.R. 15 P. 262	
40	THOMAS CADWALADER, ET UX	DO	DO	1-12-1835	REVERTS IF CANAL IS ABANDONED	
23*	PHILEMON DICKINSON	BEL DEL RR CO	DEED	9-13-1849	O.R. 10-P40 BOX 431 P. 1	
131	DO	ET UX	D & R C CO	FEE DEED	9-13-1849	O.R. 15 P. 414
132	THOMAS CADWALADER, ET UX	DO	DO	10-2-1850	O.R. 15 P. 416	
133	DO	DO	DO	10-2-1850	O.R. 15 P. 416	
290	THOMAS CADWALADER	BEL DEL RR CO	DO	9-18-1873	O.R. 11 P. 22 BOX 452 P. 6	
408	EDWARD J.C. ATTERBURY, ET UX	DO	DO	7-28-1883	O.R. 11 P. 273	
33624	CATHERINE CRANFORD	WILBUR J. FOREST	DEED	6-21-1923	BK 511 P. 429 G-28 23 BOX 2617 PK 5	
33730	STACY TRENT GARAGE	BEL DEL RR CO	DO	6-21-1923	" 514 P. 408 4-21-24 BOX 2617 PK 5	
34564	ADATH ISRAEL CONGREGATION	BEL DEL RR CO	FEE DEED	6-3-1924	BOX 2621 PK 4 CASE 3377	
34703	CHARLES J. DOUGRESS	UNJ RR & CO	DO	10-25-1926	BOX 2584 PK 12	
34704	CLARENCE H. BOND, ET UX	UNJ RR & CO	DO	5-3-1926	BOX 2569 PK 11 BK 584 P. 48	
350	ANNA WATTS	D & R C CO	DO	10-22-1849	" " P. 10 BK 590 P. 187	

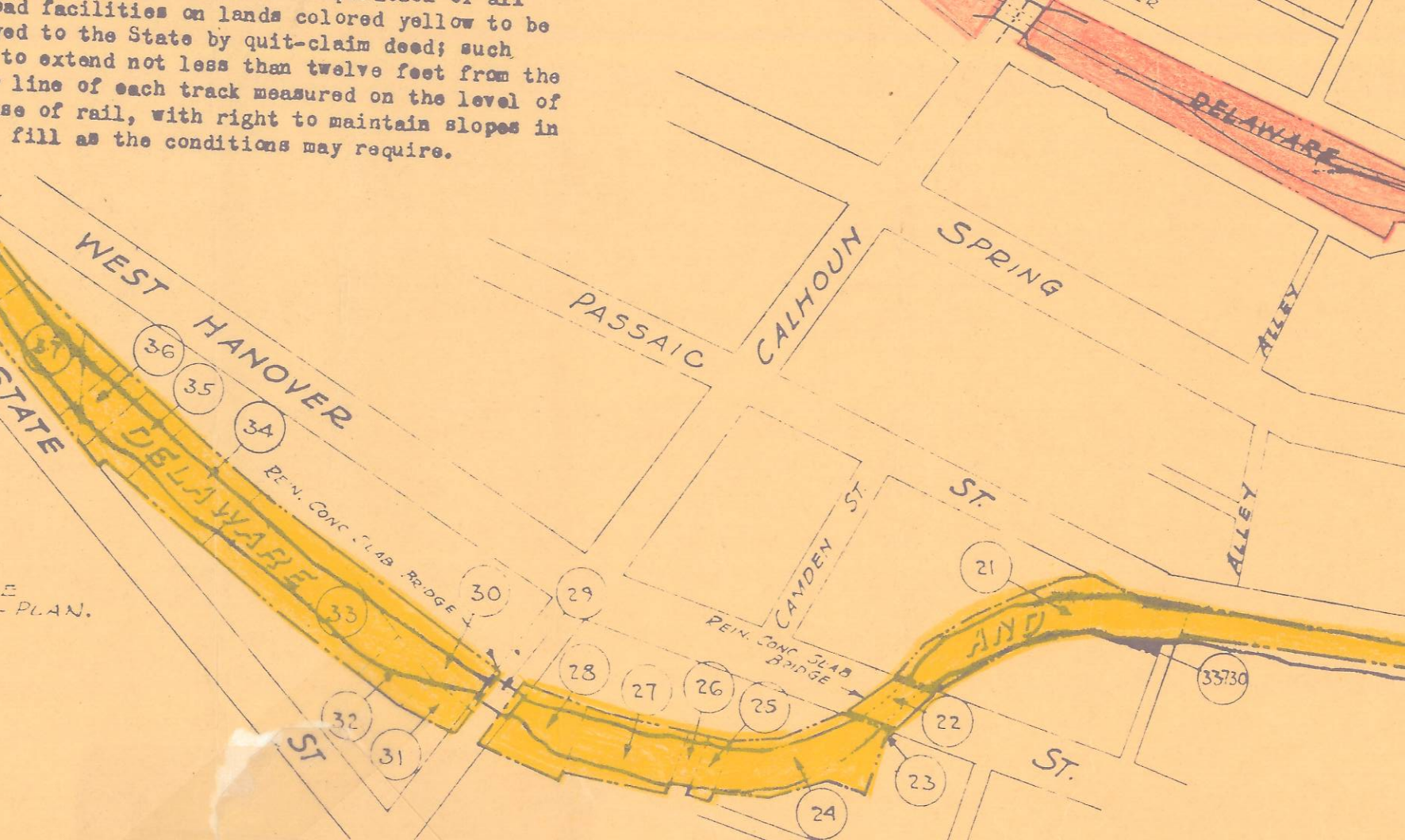

PARCEL NO.	GRANTOR	GRANTEE	KIND OF INSTRUMENT	DATE OF INSTRUMENT	REMARKS
3493	PAULINE E. MILLER	UNJ RR & CO	FEE DEED	11-10-1926	BOX 2532 P. 6 CITY RECORD 3-578 P. 50
289	PHILEMON DICKINSON, ET UX	BEL DEL RR CO	DO	3-25-1850	O.R. 11 P. 20 BOX 432 P. 6
21*	HANNA WATTS	DO	DO	10-22-1849	REFERS TO BEL DEL SERIES OF PARCELS
28*	JAMUEL C. BROWN	BEL DEL RR CO	FEE DEED	4-21-1870	REFERS TO BEL DEL SERIES OF PARCELS

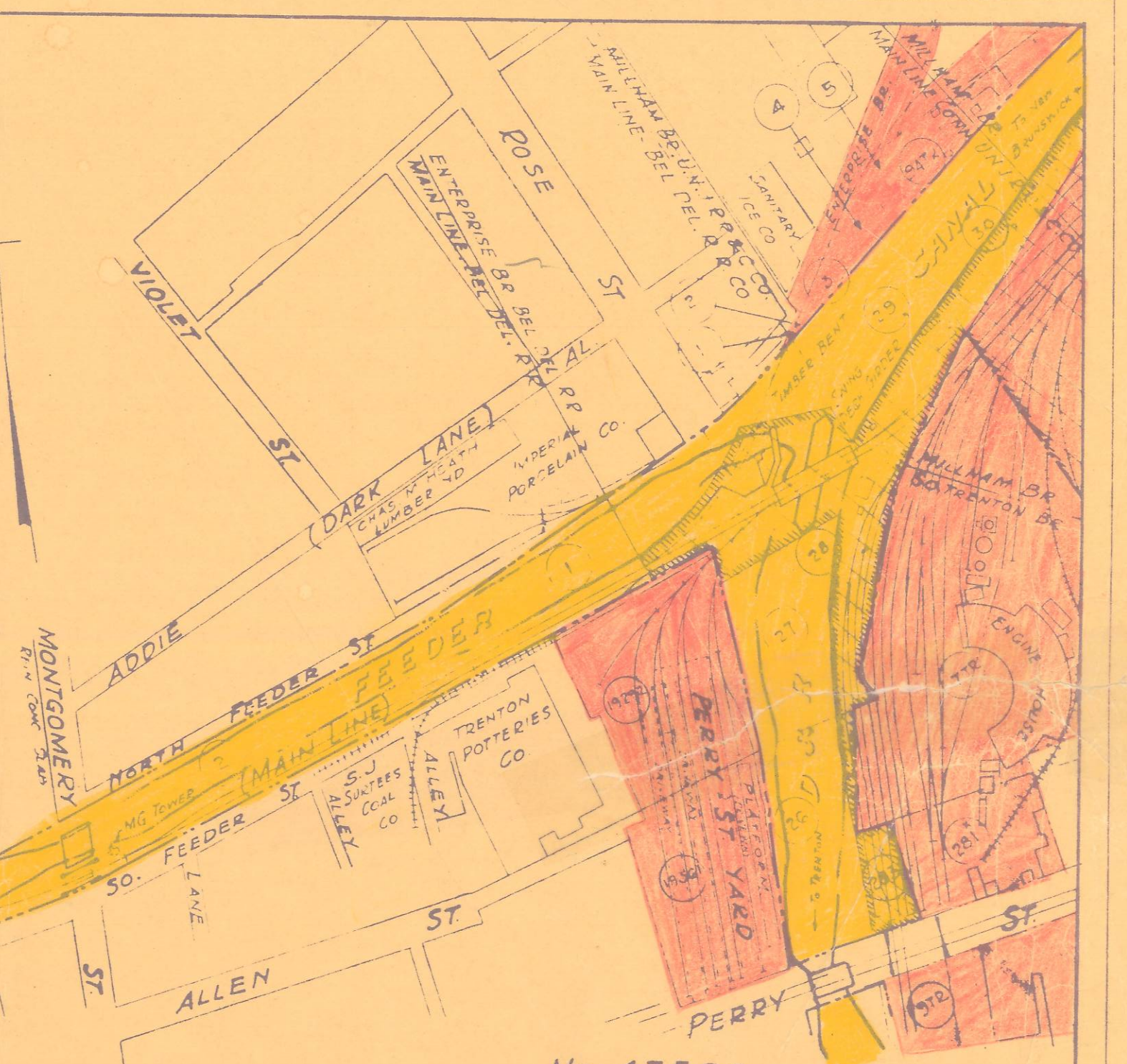
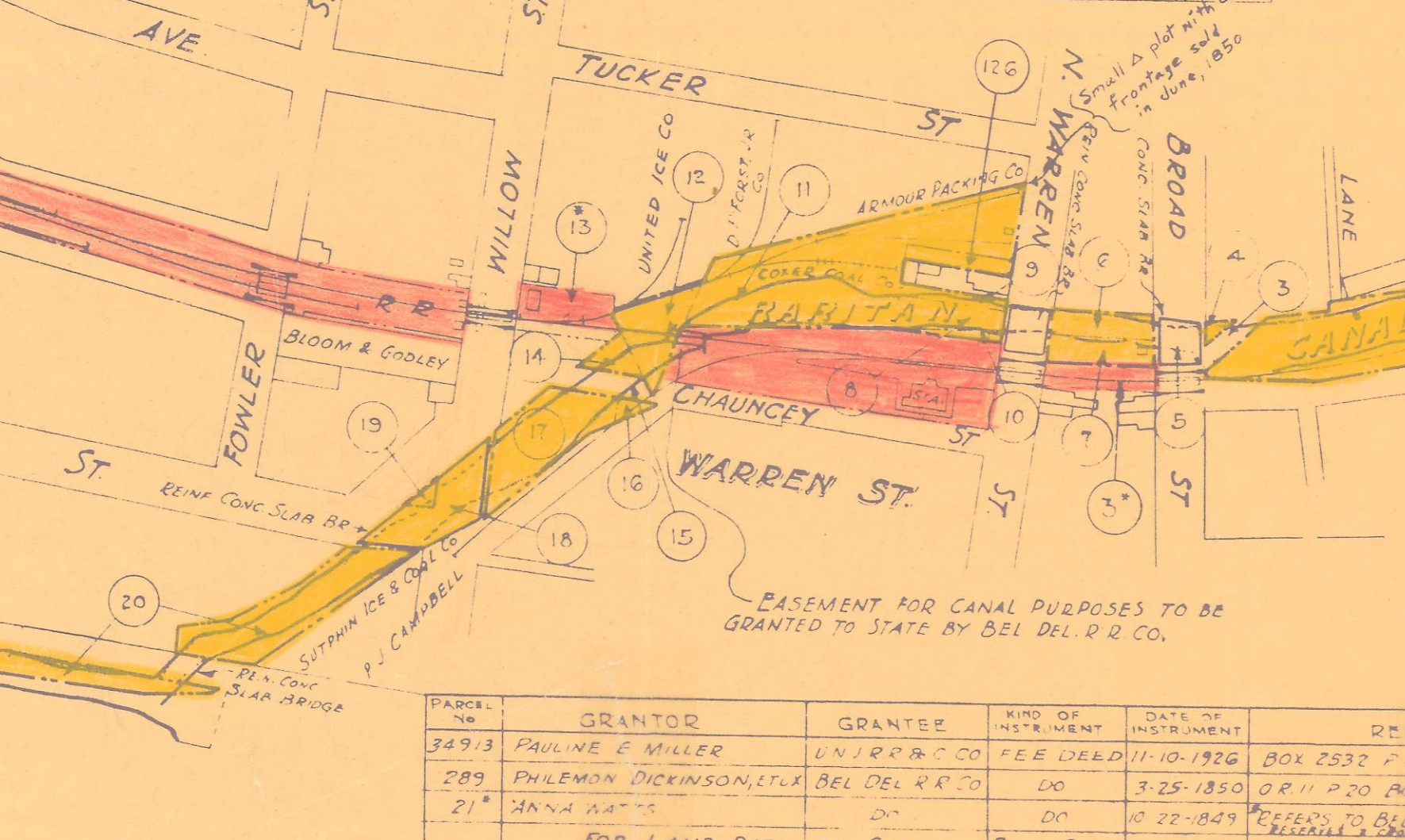

No. 47500.
 MAP SHOWING DELAWARE AND RARITAN
 CANAL AND FEEDER IN THE
 STATE OF NEW JERSEY.
 AS OF JUNE 12, 1934.
 SCALE: 1" = 200' JUNE 1, 1932. REV. SEPT. 15, 1934.